Special Licensing Sub Committee

THURSDAY, 18TH OCTOBER, 2012 at 19:00 HRS - CIVIC CENTRE, HIGH ROAD, WOOD GREEN, N22 8LE.

MEMBERS: Councillors Brabazon, Demirci and Scott

AGENDA

1. APOLOGIES FOR ABSENCE

2. URGENT BUSINESS

It being a special meeting of the Sub Committee, under Part Four, Section B, Paragraph 17, of the Council's Constitution, no other business shall be considered at the meeting.

3. DECLARATIONS OF INTEREST

A member with a disclosable pecuniary interest or a prejudicial interest in a matter who attends a meeting of the authority at which the matter is considered:

- (i) must disclose the interest at the start of the meeting or when the interest becomes apparent, and
- (ii) may not participate in any discussion or vote on the matter and must withdraw from the meeting room.

A member who discloses at a meeting a disclosable pecuniary interest which is not registered in the Register of Members' Interests or the subject of a pending notification must notify the Monitoring Officer of the interest within 28 days of the disclosure.

Disclosable pecuniary interests, personal interests and prejudicial interests are defined at Paragraphs 5-7 and Appendix A of the Members' Code of Conduct.

4. SUMMARY OF PROCEDURE (PAGES 1 - 2)

The Chair will explain the procedure that the Committee will follow for the hearing considered under the Licensing Act 2003. A copy of the procedure is attached.

5. EARL HAIG SOCIAL, ELDER AVENUE, N8 9TH (PAGES 3 - 96)

To consider an application for a new premises licence to allow supply of alcohol, provision of live music, films, recorded music and provision of facilities for dancing.

6. TURKISH CYPRIOT COMMUNITY ASSOCIATION, 628-630 GREEN LANES, N8 0SD (PAGES 97 - 132)

To consider an application by the Enforcement Response Team for a review of the premises licence at Turkish Cypriot Community Association.

David McNulty
Head of Local Democracy and Member Services
5th Floor
River Park House
225 High Road
Wood Green
London N22 8HQ

Felicity Parker
Principal Committee Coordinator
(Non Cabinet Committees)
Tel: 020-8489 2919
Fax: 020-8489 5218
Email: felicity.parker@haringey.gov.uk

Wednesday, 10 October 2012

LICENSING SUB-COMMITTEE HEARINGS PROCEDURE SUMMARY	
INTRODUCTION	
1.	The Chair introduces himself and invites other Members, Council officers, Police, Applicant and Objectors to do the same.
2.	The Chair invites Members to disclose any prior contacts (before the hearing) with the parties or representations received by them
3.	The Chair explains the procedure to be followed by reference to this summary which will be distributed.
NON-ATTENDANCE BY PARTY OR PARTIES	
4.	If one or both of the parties fails to attend, the Chair decides whether to:
(i)	grant an adjournment to another date, or
(ii)	proceed in the absence of the non-attending party.
	Normally, an absent party will be given one further chance to attend.
TOPIC HEADINGS	
5.	The Chair suggests the “topic headings” for the hearing. In the case of the majority of applications for variation of hours, or other terms and conditions, the main topic is: Whether the extensions of hours etc. applied for would conflict with the four licensing objectives i.e.
(i)	the prevention of crime and disorder,
(ii)	public safety,
(iii)	the prevention of public nuisance, and
(iv)	the protection of children from harm.
6.	The Chair invites comments from the parties on the suggested topic headings and decides whether to confirm or vary them.
WITNESSES	
7.	The Chair asks whether there are any requests by a party to call a witness and decides any such request.
8.	Only if a witness is to be called, the Chair then asks if there is a request by an opposing party to “cross-examine” the witness. The Chair then decides any such request.
DOCUMENTARY EVIDENCE	
9.	The Chair asks whether there are any requests by any party to introduce late documentary evidence.
10.	If so, the Chair will ask the other party if they object to the admission of the late documents.
11.	If the other party do object to the admission of documents which have only been produced by the first party at the hearing, then the documents shall not be admitted.

12.	If the other party object to documents produced late but before the hearing, the following criteria shall be taken into account when the Chair decides whether or not to admit the late documents:	
(i)	What is the reason for the documents being late?	
(ii)	Will the other party be unfairly taken by surprise by the late documents?	
(iii)	Will the party seeking to admit late documents be put at a major disadvantage if admission of the documents is refused?	
(iv)	Is the late evidence really important?	
(v)	Would it be better and fairer to adjourn to a later date?	
THE LICENSING OFFICER'S INTRODUCTION		
13.	The Licensing Officer introduces the report explaining, for example, the existing hours, the hours applied for and the comments of the other Council Services or outside official bodies. This should be as "neutral" as possible between the parties.	
14.	The Licensing Officer can be questioned by Members and then by the parties.	
THE HEARING		
15.	This takes the form of a discussion led by the Chair. The Chair can vary the order as appropriate but it should include:	
(i)	an introduction by the Objectors' main representative	
(ii)	an introduction by the Applicant or representative	
(iii)	questions put by Members to the Objectors	
(iv)	questions put by Members to the Applicant	
(v)	questions put by the Objectors to the Applicant	
(vi)	questions put by the Applicant to the Objectors	
CLOSING ADRESSES		
16.	The Chair asks each party how much time is needed for their closing address, if they need to make one.	
17.	Generally, the Objectors make their closing address before the Applicant who has the right to the final closing address.	
THE DECISION		
18.	Members retire with the Committee Clerk and legal representative to consider their decision including the imposition of conditions.	
19.	The decision is put in writing and read out in public by the Committee Clerk once Members have returned to the meeting.	

Licensing Act 2003 Sub-Committee on 18th October 2012

Report title: Application for a New Premises Licence at EARL HAIG SOCIAL, ELDER AVENUE, CROUCH END, LONDON N8 9TH

Report of: Licensing Team Leader

Ward(s) affected Crouch End

1. Purpose

To consider an application by Maxwell Alderman for a new premises licence to allow Supply of Alcohol, Provision of Live Music, Films, Reordered Music, Provision of Facilities for Dancing.

2. Recommendations

- 2.1**
- (a) Grant the application as asked**
 - (b) Modify the conditions of the licence, by altering or omitting or adding to them**
 - (c) Reject the whole or part of the application**

The Committee is asked to note that it may not modify the conditions or reject the whole or part of the application unless it is necessary to promote the licensing objectives.

Report authorised by: Joan Hancox

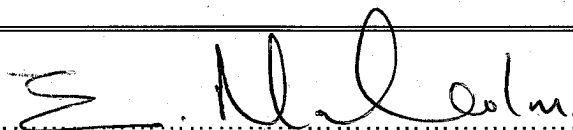

Head of Neighbourhood Services

Contact Officer: Ms Daliah Barrett-Williams

Telephone: 020 8489 8232

3. Executive summary

For consideration by Licensing Sub Committee under Licensing Act 2003 for a Premises licence with variation to the existing conditions

4. Access to information:

Local Government (Access to Information) Act 1985
Background Papers

The following Background Papers are used in the preparation of this Report:

File: Earl Haig Social

The Background Papers are located at Enforcement Service, Technopark, Ashley Road, Tottenham N17

This page is intentionally left blank

5. REPORT

Background

5.1 An application for a new Premises Licence, by Maxwell Alderman in respect of Earl Haig Social, Elder Avenue, Crouch End, London N8 9TH under the Licensing Act 2003.

5.2 Details of the application being sought under the Premises Licence–APP 1

Provision of Regulated Entertainment: Films, Live Music

Sunday to Wednesday	1200 to 2200
Thursday to Saturday	1200 to 2300

Recorded Music

Sunday to Wednesday	1200 to 0000
Thursday to Saturday	1200 to 0100

Provision of Facilities for Dancing

Monday to Thursday	1200 to 2300
Friday to Saturday	1200 to 0000
Sunday	1200 to 2200

Supply of Alcohol

Sunday to Wednesday	1100 to 0000
Thursday to Saturday	1100 to 0100

For consumption **ON** and **OFF** the premises

New Years Eve from 1200 until 0000 2nd January. 1000 until 0200 Friday, Saturday of Bank Holidays, Christmas Eve, Boxing Day. 1000 to 0200 on up to ten other event days per annum at my discretion.

Opening Hours

Monday to Wednesday	0900 to 0030
Thursday to Saturday	0900 to 0130
Sunday	1000 to 0030

New Years Eve from 1200 until 0000 2nd January. 1000 until 0200 Friday, Saturday of Bank Holidays, Christmas Eve, Boxing Day. 1000 to 0200 on up to ten other event days per annum at my discretion.

General-all four licensing objectives

The types of regulated entertainments proposed re-instate and the enhance the normal pub and family entertainments with the benefit of enhancing local facilities for social entertainment and reduce the focus on alcohol. The facilities for recorded music, live music and dancing are proposed in support of the core business of a family friendly bar and restaurant.

No new steps have been identified by my risk assessment in relation to the four licensing objectives, except as below. I have considered the terms of your local licensing policy when preparing this application.

5.3 Crime and Disorder

- Providing a 30 minute extension of opening hours after the end of the sale of alcohol will promote gradual and orderly dispersal of customers.
- No less than fourteen days notice will be provided to the council and police when 'event days' are planned.
- No use of drinks promotions such as 'happy hours'.
- Active involvement in any local 'pub watch' scheme.
- Illumination is provided to exterior of property.
- Interior and exterior covered by CCTV.
- Customers will be reminded to leave quietly and respect the neighbourhood.
- A minimum of 2 SIA approved security guards will be employed from 2100 whenever the pub is open for the sale of alcohol after midnight.

5.4 Public Safety

- No risks that are not covered by other legislation.
- The pub has a health and safety policy.
- Public transport is good to and from the premises.
- The premises will promote a local licensed taxi service.
- The pub has a strict anti-drugs policy.

5.5 Public Nuisance

- Customer departure will be actively managed.
- A sound limiter is fitted to the music system.
- Fabric of the building retains sound.

5.6 Child Protection

- The restrictions set out in the Licensing Act 2003 will apply.
- No unusual risks of harm to children have been identified.
- When on the premises children must be accompanied or supervised by a parent/guardian.
- Proof of age scheme or photo-id driving licenses.

The applicants has submitted a supporting statement at **Appendix 1A**

6. RELEVANT REPRESENTATIONS (CONSULTATION)

Responsible authorities:

6.1 Comments of Metropolitan Police

Have made representation regarding this application, but have now withdrawn their representation as they are satisfied with the control measures proposed to be implemented in relation to crime and disorder. **APP 2**

6.2 Comments of Regulatory Services:

Environmental Health

Have made representation regarding this application. **APP 3**

Trading Standards

Have made representation regarding this application, but have now withdrawn their representation as they are satisfied with the control measures proposed to be implemented in relation to the protection of children from harm. **APP 4**

Building Control

No representation made on this matter.

6.3 London Fire and Civil Defence Authority

No representation made on this matter.

6.4 Planning Services

No representation made on this matter.

6.5 Comments of Child Protection Agency or Nominee

No representation made on this matter.

7.0 Interested Parties – APP 5

Various letters of representation have been received against this application.

8.0 Financial Comments

The fee which would be applicable for this application was **£190.00**.

9.0 Licensing Officers comments

The premises was previously occupied by the British Legion and held a licence for a Club Premises Certificate, which enjoyed a 'lighter touch' approach under the Licensing Act 2003. This was due to the fact that the alcohol was for supply

to the members of the members of the club and the club operated under a written constitution.

The British Legion affiliation has now ceased and the new owners have applied for a normal premises licence to allow for the sale of alcohol and regulated entertainment on the premises and are seeking longer hours than those previously held under the Club Premises certificate.

APPENDIX 1 – APPLICATION BY ANTIC LTD

31 AUG 2012



London Borough of Haringey
Application for a premises licence
Licensing Act 2003

RECEIVED
TECHNOPARK, ASHLEY ROAD, N17 9LN

For help contact
Licensing@haringey.gov.uk
Telephone: 020 8489 8232

* required information

Section 1 of 22

You can save the form at any time and resume it later. You do not need to be logged in when you resume.

System reference

130472

This is the unique reference for this application generated by the system.

Your reference

Earl Haig Social

You can put what you want here to help you track applications if you make lots of them. It is passed to the authority.

Are you an agent acting on behalf of the applicant?

☐ Yes☒ No

Put "no" if you are applying on your own behalf or on behalf of a business you own or work for.

Applicant Details

* First name

Max

* Family name

Alderman

* E-mail

max@antic-ltd.com

Main telephone number

020 7733 8805

Include country code.

Other telephone number

020 7733 8815

☐ Indicate here if you would prefer not to be contacted by telephone

Are you:

☒ Applying as a business or organisation, including as a sole trader☐ Applying as an individual

A sole trader is a business owned by one person without any special legal structure. Applying as an individual means you are applying so you can be employed, or for some other personal reason, such as following a hobby.

Applicant Business

* Is your business registered in the UK with Companies House?

☒ Yes☐ No

* Registration number

3902705

* Business name

Antic Ltd

If your business is registered, use its registered name.

* VAT number

-

769084389

Put "none" if you are not registered for VAT.

* Legal status

Private Limited Company

*Continued from previous page...** Your position in the business Home country

The country where the headquarters of your business is located.

Registered Address

Address registered with Companies House.

* Building number or name * Street District * City or town County or administrative area * Postcode * Country

The information given here will be saved and will be pre-filled in future forms.

Section 2 of 22**PREMISES DETAILS**

I/we, as named in section 1, apply for a premises licence under section 17 of the Licensing Act 2003 for the premises described in section 2 below (the premises) and I/we are making this application to you as the relevant licensing authority in accordance with section 12 of the Licensing Act 2003.

Premises Address

Are you able to provide a postal address, OS map reference or description of the premises?

☒ Address ☐ OS map reference ☐ Description
Postal Address Of PremisesBuilding number or name Street District City or town County or administrative area Postcode Country **Further Details**Telephone number

*Continued from previous page...*Non-domestic rateable
value of premises (£)

14,750

Section 3 of 22**APPLICATION DETAILS**

In what capacity are you applying for the premises licence?

- ☐ An individual or individuals
- ☒ A limited company
- ☐ A partnership
- ☐ An unincorporated association
- ☐ A recognised club
- ☐ A charity
- ☐ The proprietor of an educational establishment
- ☐ A health service body
- ☐ A person who is registered under part 2 of the Care Standards Act 2000 (c14) in respect of an independent hospital in Wales
- ☐ A person who is registered under Chapter 2 of Part 1 of the Health and Social Care Act 2008 in respect of the carrying on of a regulated activity (within the meaning of that Part) in an independent hospital in England
- ☐ The chief officer of police of a police force in England and Wales
- ☐ Other (for example a statutory corporation)

Confirm The Following

- ☒ I am carrying on or proposing to carry on a business which involves the use of the premises for licensable activities
- ☐ I am making the application pursuant to a statutory function
- ☐ I am making the application pursuant to a function discharged by virtue of Her Majesty's prerogative

Section 4 of 22**NON INDIVIDUAL APPLICANTS**

Provide name and registered address of applicant in full. Where appropriate give any registered number. In the case of a partnership or other joint venture (other than a body corporate), give the name and address of each party concerned.

Non Individual Applicant's Name

Name

Antic Limited

*Continued from previous page...***Details**

Registered number (where applicable)

3902705

Description of applicant (for example partnership, company, unincorporated association etc)

Limited Company

Address

Building number or name

Jute House

Street

1 Valmar Works

District

Camberwell

City or town

London

County or administrative area

Southwark

Postcode

SE5 9NW

Country

United Kingdom

Contact Details

E-mail

max@antic-ltd.com

Telephone number

020 7733 8805

Other telephone number

07799 890370

Add another applicant

Section 5 of 22**OPERATING SCHEDULE**

When do you want the premises licence to start?

01

dd

/ 11

mm

/ 2012

yyyy

If you wish the licence to be valid only for a limited period, when do you want it to end

dd

/

mm

/

yyyy

If 5,000 or more people are expected to attend the premises at any one time, state the number expected to attend

Provide a general description of the premises

Continued from previous page...

For example the type of premises, its general situation and layout and any other information which could be relevant to the licensing objectives. Where your application includes off-supplies of alcohol and you intend to provide a place for consumption of these off-supplies you must include a description of where the place will be and its proximity to the premises.

Community based pub and restaurant offering a wide range of facilities to the local residents

Section 6 of 22**PROVISION OF PLAYS**

Will you be providing plays?

☐ Yes ☒ No

Section 7 of 22**PROVISION OF FILMS**

Will you be providing films?

☒ Yes ☐ No

Standard Days And Timings**MONDAY**

Start

End

Start

End

TUESDAY

Start

End

Start

End

WEDNESDAY

Start

End

Start

End

THURSDAY

Start

End

Start

End

FRIDAY

Start

End

Start

End

SATURDAY

Start

End

Start

End

Give timings in 24 hour clock.
(e.g., 16:00) and only give details for the days
of the week when you intend the premises
to be used for the activity.

Continued from previous page...

SUNDAY

Start 12:00

End 22:00

Start

End

Will the exhibition of films take place indoors or outdoors or both?

☒ Indoors

 ☐ Outdoors

 ☐ Both

Where taking place in a building or other structure tick as appropriate. Indoors may include a tent.

State type of activity to be authorised, if not already stated, and give relevant further details, for example (but not exclusively) whether or not music will be amplified or unamplified.

State any seasonal variations for the exhibition of film

For example (but not exclusively) where the activity will occur on additional days during the summer months.

Non standard timings. Where the premises will be used for the exhibition of film at different times from those listed in the column on the left, list below

For example (but not exclusively), where you wish the activity to go on longer on a particular day e.g. Christmas Eve.

Section 8 of 22**PROVISION OF INDOOR SPORTING EVENTS**

Will you be providing indoor sporting events?

☐ Yes

 ☒ No
Section 9 of 22**PROVISION OF BOXING OR WRESTLING ENTERTAINMENTS**

Will you be providing boxing or wrestling entertainments?

☐ Yes

 ☒ No
Section 10 of 22**PROVISION OF LIVE MUSIC**

Will you be providing live music?

☒ Yes

 ☐ No
Standard Days And Timings

Continued from previous page...

MONDAY

Start 12:00

End 22:00

Start

End

Give timings in 24 hour clock.
(e.g., 16:00) and only give details for the days
of the week when you intend the premises
to be used for the activity.

TUESDAY

Start 12:00

End 22:00

Start

End

WEDNESDAY

Start 12:00

End 22:00

Start

End

THURSDAY

Start 12:00

End 23:00

Start

End

FRIDAY

Start 12:00

End 23:00

Start

End

SATURDAY

Start 12:00

End 23:00

Start

End

SUNDAY

Start 12:00

End 22:00

Start

End

Will the performance of live music take place indoors or outdoors or both?

☒ Indoors ☐ Outdoors ☐ Both

Where taking place in a building or other
structure tick as appropriate. Indoors may
include a tent.

State type of activity to be authorised, if not already stated, and give relevant further details, for example (but not
exclusively) whether or not music will be amplified or unamplified.

State any seasonal variations for the performance of live music

For example (but not exclusively) where the activity will occur on additional days during the summer months.

Continued from previous page...

Non-standard timings. Where the premises will be used for the performance of live music at different times from those listed in the column on the left, list below

For example (but not exclusively), where you wish the activity to go on longer on a particular day e.g. Christmas Eve.

Section 11 of 22**PROVISION OF RECORDED MUSIC**

Will you be providing recorded music?

☒ Yes

☐ No

Standard Days And Timings**MONDAY**

Start

End

Start

End

Give timings in 24 hour clock.
(e.g., 16:00) and only give details for the days
of the week when you intend the premises
to be used for the activity.

TUESDAY

Start

End

Start

End

WEDNESDAY

Start

End

Start

End

THURSDAY

Start

End

Start

End

FRIDAY

Start

End

Start

End

SATURDAY

Start

End

Start

End

SUNDAY

Start

End

Start

End

Continued from previous page...

Will the playing of recorded music take place indoors or outdoors or both?

☒ Indoors ☐ Outdoors ☐ Both

Where taking place in a building or other structure tick as appropriate. Indoors may include a tent.

State type of activity to be authorised, if not already stated, and give relevant further details, for example (but not exclusively) whether or not music will be amplified or unamplified.

Recorded music via juke box or any other music system, including DJ, during normal business or as part of functions

State any seasonal variations for playing recorded music

For example (but not exclusively) where the activity will occur on additional days during the summer months.

Non-standard timings. Where the premises will be used for the playing of recorded music at different times from those listed in the column on the left, list below

For example (but not exclusively), where you wish the activity to go on longer on a particular day e.g. Christmas Eve.

When opening hours are extended on bank holidays and 'event days', these hours follow the opening hours

Section 12 of 22**PROVISION OF PERFORMANCES OF DANCE**

Will you be providing performances of dance?

☐ Yes ☒ No

Section 13 of 22**PROVISION OF ANYTHING OF A SIMILAR DESCRIPTION TO LIVE MUSIC, RECORDED MUSIC OR PERFORMANCES OF DANCE**

Will you be providing anything similar to live music, recorded music or performances of dance?

☐ Yes ☒ No

Section 14 of 22**PROVISION OF FACILITIES FOR MAKING MUSIC**

Will you be providing facilities for making music?

☐ Yes ☒ No

Section 15 of 22**PROVISION OF FACILITIES FOR DANCING**

Will you be providing facilities for dancing?

☒ Yes ☐ No

Continued from previous page...

Standard Days And Timings**MONDAY**Start End

Give timings in 24 hour clock.
(e.g., 16:00) and only give details for the days
of the week when you intend the premises
to be used for the activity.

Start End **TUESDAY**Start End Start End **WEDNESDAY**Start End Start End **THURSDAY**Start End Start End **FRIDAY**Start End Start End **SATURDAY**Start End Start End **SUNDAY**Start End Start End

Give a description of the type of facilities for dancing that will be provided

To enhance and improve the facilities for a community based social space.

Will the facilities for dancing be indoors or outdoors or both?

☒ Indoors
 ☐ Outdoors
 ☐ Both

Where taking place in a building or other
structure tick as appropriate. Indoors may
include a tent.

State type of activity to be authorised, if not already stated, and give relevant further details, for example (but not
exclusively) whether or not music will be amplified or unamplified.

Continued from previous page...

State any seasonal variations for the provision of dancing facilities

For example (but not exclusively) where the activity will occur on additional days during the summer months.

--

Non standard timings. Where the premises will be used for the performance of a play at different times from those listed in the column on the left, list below

For example (but not exclusively), where you wish the activity to go on longer on a particular day e.g. Christmas Eve.

--

Section 16 of 22**PROVISION OF FACILITIES FOR ENTERTAINMENT OF A SIMILAR DESCRIPTION TO THOSE PROVIDED FOR MAKING MUSIC OR DANCING**

Will you be providing facilities similar in nature to those provided for making music or dancing?

☐ Yes ☒ No

Section 17 of 22**LATE NIGHT REFRESHMENT**

Will you be providing late night refreshment?

☐ Yes ☒ No

Section 18 of 22**SUPPLY OF ALCOHOL**

Will you be selling or supplying alcohol?

☒ Yes ☐ No

Standard Days And Timings**MONDAY**

Start

End

Start

End

TUESDAY

Start

End

Start

End

WEDNESDAY

Start

End

Start

End

Give timings in 24 hour clock.
(e.g., 16:00) and only give details for the days
of the week when you intend the premises
to be used for the activity.

*Continued from previous page...***THURSDAY**Start End Start End **FRIDAY**Start End Start End **SATURDAY**Start End Start End **SUNDAY**Start End Start End

Will the sale of alcohol be for consumption:

- ☐ On the premises
 ☐ Off the premises
 ☒ Both

If the sale of alcohol is for consumption on the premises select on, if the sale of alcohol is for consumption away from the premises select off. If the sale of alcohol is for consumption on the premises and away from the premises select both.

State any seasonal variations

For example (but not exclusively) where the activity will occur on additional days during the summer months.

Non-standard timings. Where the premises will be used for the supply of alcohol at different times from those listed in the column on the left, list below

For example (but not exclusively), where you wish the activity to go on longer on a particular day e.g. Christmas Eve.

12.00 New Year's Eve until 00.00 2nd January

10.00 until 02.00 Friday, Saturday and Sunday of Bank Holidays, Christmas Eve, Boxing Day

10.00 - 02.00 on up to ten other event days per annum at my discretion

State the name and details of the individual whom you wish to specify on the licence as premises supervisor

NameFirst name Family name

*Continued from previous page...***Enter the contact's address**

Building number or name	<input type="text" value="148"/>
Street	<input type="text" value="Perry Hill"/>
District	<input type="text" value="Catford"/>
City or town	<input type="text" value="London"/>
County or administrative area	<input type="text" value="Lewisham"/>
Postcode	<input type="text" value="SE6 4EZ"/>
Country	<input type="text" value="United Kingdom"/>
Personal Licence number (if known)	<input type="text" value="LN/000002437"/>
Issuing licensing authority (if known)	<input type="text" value="LB Greenwich"/>

PROPOSED DESIGNATED PREMISES SUPERVISOR CONSENT

How will the consent form of the proposed designated premises supervisor be supplied to the authority?

- ☐ Electronically, by the proposed designated premises supervisor
- ☒ As an attachment to this application

Reference number for consent form (if known)

If the consent form is already submitted, ask the proposed designated premises supervisor for its 'system reference' or 'your reference'.

Section 19 of 22**ADULT ENTERTAINMENT**

Highlight any adult entertainment or services, activities, or other entertainment or matters ancillary to the use of the premises that may give rise to concern in respect of children

Give information about anything intended to occur at the premises or ancillary to the use of the premises which may give rise to concern in respect of children, regardless of whether you intend children to have access to the premises, for example (but not exclusively) nudity or semi-nudity, films for restricted age groups etc gambling machines etc.

None proposed.

Section 20 of 22**HOURS PREMISES ARE OPEN TO THE PUBLIC****Standard Days And Timings**

MONDAY

Start

End

Start

End

Give timings in 24 hour clock.
(e.g., 16:00) and only give details for the days of the week when you intend the premises to be used for the activity.

Continued from previous page...**TUESDAY**Start End Start End **WEDNESDAY**Start End Start End **THURSDAY**Start End Start End **FRIDAY**Start End Start End **SATURDAY**Start End Start End **SUNDAY**Start End Start End

State any seasonal variations

For example (but not exclusively) where the activity will occur on additional days during the summer months.

Non standard timings. Where you intend to use the premises to be open to the members and guests at different times from those listed in the column on the left, list below

For example (but not exclusively), where you wish the activity to go on longer on a particular day e.g. Christmas Eve.

0.00 New Year's Eve until 00.30 2nd January

10.00 until 02.30 Friday, Saturday and Sunday of Bank Holidays, Christmas Eve, Boxing Day

10.00 - 02.30 on up to ten other event days per annum at my discretion

Section 21 of 22**LICENSING OBJECTIVES**

Describe the steps you intend to take to promote the four licensing objectives:

a) General – all four licensing objectives (b,c,d,e)

Continued from previous page...

List here steps you will take to promote all four licensing objectives together.

The types of regulated entertainments proposed re-instate and the enhance the normal pub and family entertainments with the benefit of enhancing local facilities for social entertainment and reduce the focus on alcohol.
The facilities for recorded music, live music and dancing are proposed in support of the core business of a family friendly bar and restaurant.
No new steps have been identified by my risk assesment in relation to the four licensing objectives, except as below.
I have considered the terms of your local licensing policy when preparing this application.

b) The prevention of crime and disorder

Providing a 30 minute extension of opening hours after the end of the sale of alcohol will promote gradual and orderly dispersal of customers.
No less than fourteen days notice will be provided to the council and police when 'event days' are planned.
No use of drinks promotions such as 'happy hours'
Active involvement in any local 'pub watch' scheme.
Illumination is provided to exterior of property.
Interior and exterior covered by CCTV
Customers will be reminded to leave quietly and respect the neighbourhood
A minimum of 2 SIA approved security guards will be employed from 21.00 whenever the pub is open for the sale of alcohol after midnight

c) Public safety

No risks that are not covered by other legislation.
The pub has a health and safety policy
Public transport is good to and from the premises
The premises will promote a local licensed taxi service
The pub has a strict anti-drugs policy

d) The prevention of public nuisance

Customer departure will be actively managed
A sound limiter is fitted to the music system
Fabric of the building retains sound

e) The protection of children from harm

The restrictions set out in the Licensing Act 2003 will apply
No unusual risks of harm to children have been identified
When on the premises children must be accompanied or supervised by a parent/guardian
Proof of age scheme or photo -id driving licenses.

Section 22 of 22

PAYMENT DETAILS

This fee must be paid to the authority. If you complete the application online, you must pay it by debit or credit card.
Premises Licence Fees are determined by the non domestic rateable value of the premises.

To find out a premises non domestic rateable value go to the Valuation Office Agency site at http://www.voa.gov.uk/business_rates/index.htm

Continued from previous page...

Band A - No RV to £4300	£100.00
Band B - £4301 to £33000	£190.00
Band C - £33001 to £8700	£315.00
Band D - £87001 to £12500	£450.00*
Band E - £125001 and over	£635.00*

*If the premises rateable value is in Bands D or E and the premises is primarily used for the consumption of alcohol on the premises then you are required to pay a higher fee

Band D - £87001 to £12500	£900.00
Band E - £125001 and over	£1,905.00

There is an exemption from the payment of fees in relation to the provision of regulated entertainment at church halls, chapel halls or premises of a similar nature, village halls, parish or community halls, or other premises of a similar nature. The costs associated with these licences will be met by central Government. If, however, the licence also authorises the use of the premises for the supply of alcohol or the provision of late night refreshment, a fee will be required.

Schools and sixth form colleges are exempt from the fees associated with the authorisation of regulated entertainment where the entertainment is provided by and at the school or college and for the purposes of the school or college.

If you operate a large event you are subject to ADDITIONAL fees based upon the number in attendance at any one time

Capacity 5000-9999	£1,000.00
Capacity 10000 -14999	£2,000.00
Capacity 15000-19999	£4,000.00
Capacity 20000-29999	£8,000.00
Capacity 30000-39000	£16,000.00
Capacity 40000-49999	£24,000.00
Capacity 50000-59999	£32,000.00

Continued from previous page...

Capacity 60000-69999	£40,000.00
Capacity 70000-79999	£48,000.00
Capacity 80000-89999	£56,000.00
Capacity 90000 and over	£64,000.00

The following credit or debit cards are accepted in Haringey:

Maestro - Mastercard Debit - Mastercard Credit - Solo - Visa Credit - Visa Debit (formerly Delta) and Visa Electron

We cannot accept liability if payment is refused or declined by the card supplier.

Due to end of day processing, this service will not be available between 10pm and 11pm every weekday evening (Mon- Fri).

Users should note that any payments in process after the 10pm deadline need to be completed by 10.05pm

* Fee amount (£)

ATTACHMENTS

- ☐ Premises plan
- ☐ Consent form of premises supervisor

AUTHORITY POSTAL ADDRESS**Address**

Building number or name

Street

District

City or town

County or administrative area

Postcode

Country

DECLARATION

* I/we understand it is an offence, liable on conviction to a fine up to level 5 on the standard scale, under section 158 of the licensing act 2003, to make a false statement in or in connection with this application.

☐ Ticking this box indicates you have read and understood the above declaration

This section should be completed by the applicant, unless you answered "Yes" to the question "Are you an agent acting on behalf of the applicant?"

* Full name

* Capacity

Continued from previous page...	
Date (dd/mm/yyyy)	<input type="text"/>
<div>Add another signatory</div>	



London Borough of Haringey
Consent to be designated
Licensing Act 2003

For help contact
Licensing@haringey.gov.uk
 Telephone: 020 8489 8232

* required information

Section 1 of 3

You can save the form at any time and resume it later. You do not need to be logged in when you resume.

System reference

130327

This is the unique reference for this application generated by the system.

Your reference

You can put what you want here to help you track applications if you make lots of them. It is passed to the authority.

Are you an agent acting on behalf of the applicant?

☐ Yes ☒ No

Put "no" if you are applying on your own behalf or on behalf of a business you own or work for.

Applicant Details

* First name

Max

* Family name

Alderman

* E-mail

max@antic-ltd.com

Main telephone number

020 7733 8805

Include country code.

Other telephone number

020 7733 8815

☐ Indicate here if you would prefer not to be contacted by telephone

Are you:

☒ Applying as a business or organisation, including as a sole trader
☐ Applying as an individual

A sole trader is a business owned by one person without any special legal structure. Applying as an individual means you are applying so you can be employed, or for some other personal reason, such as following a hobby.

Applicant Business

* Is your business registered in the UK with Companies House?

☒ Yes ☐ No

* Registration number

3902705

* Business name

Antic Ltd

If your business is registered, use its registered name.

* VAT number

- 769084389

Put "none" if you are not registered for VAT.

* Legal status

Private Limited Company

Continued from previous page...

* Your position in the business

Home country

The country where the headquarters of your business is located.

Registered Address

Address registered with Companies House.

* Building number or name

* Street

District

* City or town

County or administrative area

* Postcode

* Country

The information given here will be saved and will be pre-filled in future forms.

Section 2 of 3**CONSENT****Name Of Proposed Premises Supervisor**

* First name

* Family name

Address Of Proposed Premises Supervisor

* Building number or name

* Street

District

* City or town

County or administrative area

Postcode

* Country

I hereby confirm that I give my consent to be specified as the designated premises supervisor in relation to the following application, and any premises licence to be granted or varied in respect of this application concerning the supply of alcohol at the premises

* Type of application

For instance 'Application for a premises licence' or 'Variation of a premises licence'

Is the application or variation that this consent is being submitted in connection with being supplied electronically to the authority

☒ Yes ☐ No ☐ Don't know

*Continued from previous page...*Reference number of
electronic application (if
known)If the application or variation form is already
submitted, ask its applicant for the form's
'system reference' or 'your reference'.**Premises Licence Holder*** Name **Address Of Premises*** Building number or name * Street District * City or town County or administrative area Postcode **Premises**Premise licence number * Name of premises

I also confirm that I am applying for, intend to apply for or currently hold a personal licence, details of which I set out below

Personal licence number Personal licence issuing
authority name **Address Of Personal Licence Issuing Authority**Building number or name Street District City or town County or administrative area Postcode **Contact Details Of Personal Licence Issuing Authority**Telephone number **Section 3 of 3****DECLARATION**

Continued from previous page...

* I/we understand it is an offence, liable on conviction to a fine up to level 5 on the standard scale, under section 158 of the licensing act 2003, to make a false statement in or in connection with this application.

☐ Ticking this box indicates you have read and understood the above declaration

This section should be completed by the applicant, unless you answered "Yes" to the question "Are you an agent acting on behalf of the applicant?"

* Full name

* Capacity

Date (dd/mm/yyyy)

Add another signatory

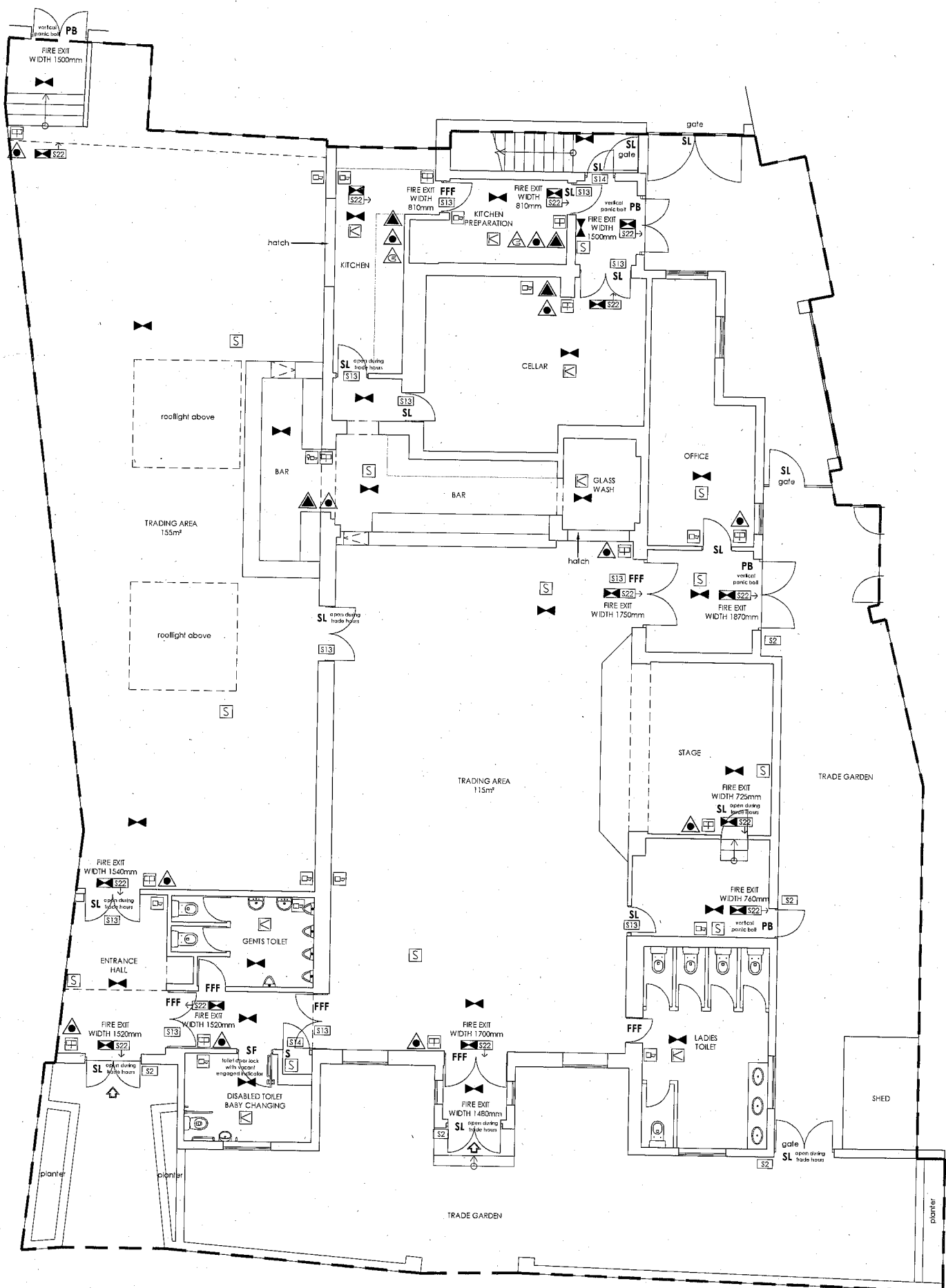

ELDER AVENUE

ANTIC LTD

Jute House, 1 Valmar works Camberwell, SE5 9NW	T: 020 7733 8805 F: 020 7733 8815
---	--------------------------------------

ADDRESS	Earl Haig Social, Elder Avenue, Crouch End, N8 9TH
---------	---

DRAWING	cross end, NB
DRAWING NO.	Licensing plan EUS 1.0.01

DRAWING NO.	EHS-LP-01
SCALE	1:100 @ A3

DATE 21/08/2012
ANTIC LTD copyright reserved

DRAWN BY Ignius Pupinis

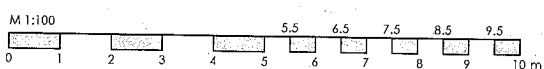

Anderson Chanel

From: Max Alderman [max@antic-ltd.com]
Sent: 24 September 2012 11:40
To: Shah Noshaba
Cc: Anderson Chanel
Subject: RE: Earl Haig Social, Elder Avenue, Hornsey, London, N8 9TH.
Attachments: Earl Haig Social.docx

Good morning

Apologies we should have included this with our application but perhaps I can submit it now to give a better idea of our intentions for the Earl Haig.

Obviously this will go to committee but feel this will be useful in any case.

Kind regards

Max Alderman
Antic Ltd
Jute House
1 Valmar Works
London
SE5 9NW

020 7733 8805
max@antic-ltd.com

www.antic-ltd.com

From: Shah Noshaba [mailto:Noshaba.Shah@haringey.gov.uk]
Sent: 24 September 2012 09:57
To: 'max@antic-ltd.com'
Subject: Earl Haig Social, Elder Avenue, Hornsey, London, N8 9TH.

Dear Sir/ Madam,

Please find attached representations received from residents in regards to the application for a new premises licence for the above premises.

If you have any further enquiries please do not hesitate to contact me.

Yours sincerely

Noshaba Shah
Licensing Officer
Urban Environment
Tel: 020 8489 5536
Fax: 020 8489 5133
Email: licensing@haringey.gov.uk

25/09/2012

Earl Haig Social
Elder Avenue, N8 9TH

Current Use

The premises previously operated as the Earl Haig Memorial Hall, a British Legion establishment, built in 1928 and until its closure some 18 months ago, traded as a member's only social club.

In common with many clubs of this type, membership in the immediate area has dwindled over recent years and the club became increasingly unviable and the British Legion decided to dispose of the premises.

Building

The building is very much of its time and whilst not listed or of great architectural merit, it is an interesting building nonetheless, both externally and internally. We therefore believe that it should be retained if at all possible, although it will require a revised use for this to occur. It sits near the end of Elder Avenue, immediately behind the commercial premises along Tottenham Lane, so whilst it is on a residential road, it is at the commercial end of it.

The building is very much laid out as a social club of yesteryear, with very 70's style fixtures and fittings, complete with a small variety club type stage, bars and the like. There is a delivery gate to the rear, a strip of side yard along its Northern flank which would make an interesting external terrace and a small forecourt to the front.

The building is rather tired and in some disrepair and will require significant investment to bring it back up to a suitable state of repair. However, the internal features provide a fantastic backdrop to provide a quirky and unusual internal space that is very much in keeping with the building, its history and the nature of Crouch End. It is very much the sort of premises we love to breath new life into.

Proposed Use

The intention is to continue the bar and social side of the original club, whilst opening it to a wider local demographic, hence the need to apply for a new premises license to replace the previous club certificate. The legal requirements for Premises licenses are in many ways significantly more stringent than those for club certificates and thus this will lead to the future operation being run on a tighter basis than that historically.

The application seeks hours from Sunday to Wednesday until midnight on the basis that since the Licensing Act 2003, the consumption of alcohol, as was hoped, has spread throughout the day and evening, providing greater flexibility for patrons. There is now an expectation from the public that this is the case and these hours better suit the increased working hours of many Londoners. Many people no longer finish work until the early evening and so their use of such establishments is therefore later.

We believe that the premises previously traded until 02:00 and so have reduced the hours on Thursday to Saturdays to 01:00 the morning following, in acknowledgement of the residential nature of our immediate neighbours and will ensure that the garden is not used beyond 21:30.

Style

We will seek to offer a comfortable, retro environment that makes the best use of the existing features of the building, but updated for modern use including the provision of disabled access and baby changing facilities. We have a very similar property called the Balham Bowling Club, that is extremely similar in style and whilst it has a wide audience, it is firmly aimed at the middle classes. We respect our customers and have an expectation that this is reciprocated. The Earl Haig will be run in a similar vein and will have the general feel of a well-worn and loved community asset, which will provide a distinct service to local residents. So whether it is meeting friends for a catch up, treating your partner to dinner, bringing the family for Sunday lunch, celebrating a birthday or holding your wedding reception, the Earl Haig will be a suitable home from home.

The bar will feature a wide range of real ales, (including two of our own brews, shortly to be produced from our new brewery in Camberwell), some continental beers, a concise but well sourced wine list and a reasonable range of spirits for those of that inkling.

The food will be reasonably priced but of a 'gastro pub' level, Simon Phelan our Executive Chef will be responsible for recruiting a Head Chef who is capable of creating and delivering a modern British menu that will feature the best of UK produce that is always responsibly and ethically sourced but at a price point to put many of our competitors to shame. Essentially main courses will be in the £8.00 to £12.00 price bracket, but with the quality to attract recognition as some of the best in London, indeed when Simon joined us The Antelope, our pub in Tooting, was nominated as Best New Gastro pub in Time Out that year and has continued to be recognised amongst the best in London. Food will therefore be a very important part of what we will do at the Earl Haig and will probably make up a third of our revenue, from great Sunday roasts, bbq's in the warmer months and subsidised OAP lunches at Christmas, and all parts in between.

We have sought to retain some regulated entertainment including live music, though this will cease before the terminal hour with recorded music to allow the continued use of the space as a vibrant, but civilised retention of a dying breed of social clubs in the locality.

Conclusion

In summary we want to provide a high quality, fairly priced and quirky social amenity, to the residents of Crouch End, which provides all that such establishments once did. The premises needs to be updated in order to better meet the requirements of the 21st Century, but the essence of providing a convivial, comfortably and welcoming place to relax is as old as London itself, and this is at the heart of what the Earl Haig should be. The club has been in this location for over 80 years and we would like to think that in a slightly altered guise, it will remain so for many decades to come.

Anderson Chanel

From: Max Alderman [max@antic-ltd.com]
Sent: 08 October 2012 13:52
To: Anderson Chanel
Subject: FW: Royal British Legion Hall Crouch End/Earl Haig
Attachments: letter_template[1].doc

Hi Chanel

Please see a letter of support from a councillor at Waltham Forest.

Do we have an idea when the committee is likely to be yet?

Max Alderman
Antic Ltd
Jute House
1 Valmar Works
London
SE5 9NW

020 7733 8805
max@antic-ltd.com

www.antic-ltd.com

From: anthony@antic-ltd.com [mailto:anthony@antic-ltd.com]
Sent: 08 October 2012 12:44
To: Max
Subject: Fw: Royal British Legion Hall Crouch End

M,

Can you pass on the attached in support of our application for Earl Haig.

A
Sent using BlackBerry® from Orange

This email has been scanned by the Symantec Email Security.cloud service.
For more information please visit <http://www.symanteccloud.com>

Councillor Clyde Loakes

Deputy Leader and Cabinet Member for Environment



Waltham Forest Town Hall,
Forest Road,
Walthamstow,
London E17 4JF

To Whom it may concern

Ask for: Cllr Clyde Loakes
Our Ref: CL/MK
Your Ref:
Email: Cllr.clyde.loakes@walthamforest.gov.uk
Direct line: 020 8496 4841
Direct fax:
Date:
8th October
2012

Dear Sir/ Madam

Re: British Legion Hall- Crouch End

Antic Pubs bought one of Waltham Forest's most troubled pubs- 'Zulus'- 2 years ago and after a substantial refurbishment it has been open for some 18 months now. It is now a thriving gastro pub with very good quality foods and a very significant range of rotating gues ales. It has already won a couple of CAMRA awards for its beers!

Zulus was a cause of constant ASB in the Leytonstone Town Centre and it added nothing but heartache and grief to this crucial district town centre.

The owners of Antic on the other hand have invested heavily in the town centre, both financially in refurbishing Zulus- now returned to its original iconic name of the Red Lion- and in the community, economic and social life of the town centre. They engage with the local ward councillor's- of which I am one-, residents associations and community groups on a regular basis.

They host a regular arts and crafts 'pop up' market- 'Lion Heart Market'-, a pensioners Christmas Dinner, Beer Festivals and numerous arts and cultural events including in the Leytonstone Arts Trail and Leytonstone Festival. The pub also has a very solid and positive approach to allowing families into the pub.

In the 18 months since Antic opened the Red Lion I have not had a single complaint about its management, clientele and opening hours. In fact on the contrary we get compliments! To the extent where we are positively encouraging Antic to look at trying to acquire other troubled pubs in Waltham Forest.

In short Antic have given Leytonstone the kind of gastro pub we, our residents and town centre business community have always wanted and it has added significantly to our town centre. My conclusion is that Antic only run good and very well managed pubs and should be viewed as an asset to any community.



Yours sincerely

Councillor Clyde Loakes
Leytonstone Ward Cllr
LB Waltham Forest

APPENDIX 2 – METROPOLITAN POLICE REPRESENTATION NOW WITHDRAWN

**METROPOLITAN
POLICE**
Working together for a safer London

POLICE REPRESENTATION

Name and address of premises:

Earl Haig Social, Elder Avenue N8 9TH

Type of Application: New Premises Licence.

I wish to make representation on the following:

- Prevention of crime and disorder

If this application were granted in full or part, I would recommend the following alterations be made to the licence conditions. I also suggest that additional conditions be attached to the licence, as set out below, to further promote the licensing objectives.

	Current Conditions		Recommendation
1	CCTV system to be installed.		<p>A digital CCTV system to be installed in the premises.</p> <p>Cameras must be sited to observe the entrance doors from the inside.</p> <p>Cameras on the entrances must capture full frame shots of the heads and shoulders of all people entering the premises i.e. capable of identification.</p> <p>Provide a linked record of the date, time, and place of any image.</p> <p>Provide good quality images - colour during opening times.</p>

			<p>Have a monitor to review images and recorded quality.</p> <p>Be regularly maintained to ensure continuous quality of image capture and retention.</p> <p>Staff trained in operating CCTV.</p> <p>Digital images must be kept for 31 days. The equipment must have a suitable export method, e.g. CD/DVD writer so that Police can make an evidential copy of the data they require. Copies must be available within a reasonable time to Police on request.</p>
2	Show films.		Any film shown that does not have a certificate issued by the British Board of Film Censors must have a copy deposited with Haringey Council Licensing Department prior to its showing.
Additional Conditions Requested by the Metropolitan Police		Applicant Agree	

If these conditions were accepted in full I would withdraw my representation.

Officer: Mark Greaves
Licensing Officer Haringey Police

Tel: 020 3276 0150

Mark.Greaves@Met.Police.UK

Date: 14th September 2012

**APPENDIX 3 – ENVIRONMENTAL HEALTH – ENFORCEMENT RESPONSE
REPRESENTATION**

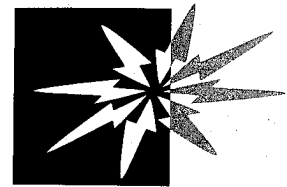

Haringey Council

Licensing Consultation

To: Daliah Barrett-Williams

From: Enforcement Response Officer (Noise)

Name of Officer preparing representation: George Roberts

cc: Team Leader Enforcement Response, Derek Pearce

Our Reference: WK/000229492

Date: 27th September 2012

Premises: Earl Haig Social, Elder Avenue, Crouch End, London, N8 9TH

Type of application: New

I would like to confirm that I have considered the above proposal with regard to the prevention of public nuisance on behalf of the Enforcement Response (Noise) Team & would like to make representations to the Application

The operating schedule does not address the prevention of public nuisance from:

- airborne entertainment noise
- Structure borne noise or vibrations from entertainment
- Noise generated by patrons in external areas of the premises
- Noise from patrons exiting the premises
- Noise generated from deliveries
- Noise generated from refuse collections
- Noise from plant and machinery
- Light nuisance
- Cooking odour

The proposed operating hours are inappropriate due to the close proximity of residential dwellings

The noise caused by patrons exiting the premises and locating suitable transport home is likely to be detrimental to the residential amenity. This may be exacerbated by the level of public transport available at the proposed closing hours.

Supporting Information

No relevant history of any complaints to enforcement response

This representation recommends that the following alterations/conditions to the operating schedule:

Operating hours

In the section relating to non standard opening times, the application makes reference to "members and guests". The whole section should be removed as it is not a club premises certificate which is being sought.

In section relating to non standard sale of alcohol times to only allow 1200 hrs New Years Eve until 0000 hrs 1st January – Other wording to be removed for this section.

Reason: To prevent noise nuisance to local residents.

Prevention of nuisance from noise / vibration

All doors and windows will remain closed during the licensed regulated entertainment activities or in any event after 11pm. The entrance door will be fitted with a self-closing device and staff required to ensure that it is not propped open. A member of staff shall be made responsible to ensure the door is opened for as brief a period as possible. Where necessary adequate and suitable mechanical ventilation should be provided to public areas

Entry to the premises will be restricted to one set of doors whilst the premises is being used for regulated entertainment licensed activity

Entrance/exit from the premises whilst regulated entertainment licensable activities are ongoing shall be via a lobbied door to minimise noise breakout.

Structure borne noise

All speakers are mounted on anti-vibration mountings to prevent vibration transmission of sound energy to adjoining properties

The condition volunteered by the applicant which states "Fabric of the building retains sound" should be removed.

Sound limits

The licensee shall ensure that no music played in the licensed premises is audible at or within the site boundary of any residential property

The condition volunteered by the applicant in relation to fitting a sound limiter should be reworded to state – "A sound limiter to be fitted, maintained and staff trained in its use. All forms of amplified music have to run through the fitted sound limiter"

Outside Areas

No music will be played in, or for the benefit of patrons in external areas of the premises

No form of loudspeaker or sound amplification equipment is to be sited on or near the exterior premises or in or near any foyer, doorway, window or opening to the premises

Signs shall be displayed in the external areas/on the frontage requesting patrons to recognise the residential nature of the area and conduct their behaviour accordingly. The management must reserve the right to ask patrons to move inside the premises or leave if it is felt that they could be disturbing neighbours

Only patrons seated at tables will be permitted in the beer garden or external areas

The external area /frontage will be closed and patrons requested to come inside the main structure of the premises at 2200 hrs

Deliveries and collections.

Deliveries and collections associated with the premises will be arranged between the hours 0800 hrs and 1800 hrs so as to minimise the disturbance caused to the neighbours

Glasses and bottles will be collected from the rear external areas at the beginning of the day rather than at closing time when neighbours in close proximity might be unduly disturbed

Glasses and bottles to be collected from the front areas immediately after it is closed to the public.

Empty bottles and non-degradable refuse will remain in the premises at the end of trading hours and taken out to the refuse point at the start of the working day rather than at the end of trading when neighbours might be unduly disturbed

Plant and machinery

All plant and machinery is correctly maintained and regularly serviced to ensure that it is operating efficiently and with minimal disturbance to neighbours arising from noise

Dealing with complaints

A complaints book will be held on the premises to record details of any complaints received from neighbours. The information is to include, where disclosed, the complainant's name, location, date time and subsequent remedial action undertaken. This record must be made available at all times for inspection by council officers

Patrons entering/exiting premises.

Signs should be displayed internally requesting patrons to respect the neighbours and behave in a courteous manner

When the premises turn out, a licensed door supervisor shall supervise patrons and ensure they leave in a prompt and courteous manner, respecting the neighbours.

A licensed door supervisor will be positioned on the exit door to ensure, as far as reasonably practical, that patrons do not leave drinks.

A licensed door supervisor will patrol the curtilage of the premises to prevent patrons urinating in public areas in the vicinity of the premises.

Prevention of Nuisance from Odour

All ventilation and extraction systems shall be correctly maintained and regularly serviced to ensure that it is operating efficiently and with minimal disturbance to neighbours arising from odour.

Prevention of nuisance from light

Illuminated external signage shall be switched off when the premises is closed

Security lights will be positioned to minimise light intrusion to nearby residential premises

APPENDIX 4 – TRADING STANDARDS REPRESENTATION – NOW WITHDRAWN

Anderson Chanel

From: Tillett Karen
Sent: 04 September 2012 17:20
To: Anderson Chanel
Subject: RE: New Premises Application - Earl Haig Social, Elder Avenue, Crouch End, London N8 9TH

Dear Chanel,

I would like to make a representation on behalf of Trading Standards regarding the potential sale of alcohol to children.

The prevention of such activity is not addressed in Section 21(e) in sufficient detail.

Measures that we would expect to see in place are detailed below:

- To clarify what age verification policy is in place in relation to the sale of alcohol, e.g. Challenge 21. The policy must require individuals who appear to be under the specified age to produce on request, before being sold alcohol, identification bearing their photograph, date of birth and a holographic mark.
- All relevant staff must be trained in the prevention of underage sales including: knowledge of the law and guidance on how to assess age and recognise acceptable ID.
- To keep a written record of staff training confirming that they have understood the legal requirements; signed and dated by the trainer and the trainee.

Kind regards,
Karen

Karen Tillett
Joint Trading Standards Manager - Haringey and Waltham Forest
London Borough of Haringey Trading Standards
Lee Valley Technopark,
Ashley Road, Tottenham
London N17 9LN
Telephone: 020 8489 5885
Alt Telephone: 020 8489 8233
Fax: 020 8489 5554

From: Anderson Chanel
Sent: 31 August 2012 14:33
To: Building Control; Enforcement Response; 'Fire'; Food Haringey; Pearce Derek; Planning Enforcement; Whitehouse Rebecca; Tillett Karen; Thomas Simon; 'YR_Licensing@met.pnn.police.uk'
Cc: Barrett Daliah; Smith Paul; Shah Noshaba
Subject: New Premises Application - Earl Haig Social, Elder Avenue, Crouch End, London N8 9TH
Importance: High

Dear RA's

Please find attached a new application for a premises licence for the above premise.

10/09/2012

APPENDIX 5 – LETTERS OF REPRESENTATION FROM ‘OTHER PARTIES’

Shah Noshaba

From: Barrett Daliah on behalf of Licensing
Sent: 17 September 2012 10:03
To: Shah Noshaba
Subject: FW: Earl Haig Memorial building

From: james key [mailto:████████████████████@nmail.com]
Sent: 16 September 2012 20:39
To: Licensing
Subject: Earl Haig Memorial building

Dear Sir or Madam

I am writing to oppose the licencing application for the Earl Haig Memorial building.

My family live directly opposite the the Earl Haig Memorial. It is a quiet residential street and we would certainly suffer from the increased noise from live and recorded music, especially very late at night and in the early mornings. Consumption of alcohol both inside and outside the building will inevitably mean loud voices, shouting, smoking on the street and possibly antisocial behaviour of people outside and in leaving the building. The houses along Elder Avenue are old victorian buildings. Their bedrooms have single glazed windows and face the street. This would certainly mean residents will find it difficult to sleep at night. I have a small child and this will without doubt spoil our quality of life.

I strongly oppose this application as it will have a direct impact on the environment in which my family live.

James Key
17 Elder Avenue
N8 9TE

This email has been scanned by the Symantec Email Security.cloud service.
For more information please visit <http://www.symanteccloud.com>

Anderson Chanel

From: Barrett Daliah on behalf of Licensing
Sent: 01 October 2012 13:22
To: Anderson Chanel
Subject: FW: Earl Haig Memorial, Elder Avenue

From: Theodora Nathanael [mailto:theo3624@yahoo.com]
Sent: 21 September 2012 13:07
To: Licensing
Subject: Earl Haig Memorial, Elder Avenue

To Licensing Dept.

As our house is right on the corner of Elder Avenue and Fairfield Gardens and my bedroom is on that corner. It would affect us in a big way. My main concerns would be more of what I have now: bottles of drink left on my drive wall, people sitting on the wall and dropping rubbish and food onto the drive, noise and fights. I'm do not think it will have a positive effect on our neighbourhood.

I should add that one of the worst things about another pub opening is what I discovered a few weeks ago. I found a woman's skirt with two piles of excrement nearby on my drive. This sort of thing could get worse with another pub so close by.

Yours sincerely
Theodora Nathanael
GF 23 Elder Avenue
N8 9TE

This email has been scanned by the Symantec Email Security.cloud service.
For more information please visit <http://www.symanteccloud.com>

Shah Noshaba

From: Barrett Daliah on behalf of Licensing
Sent: 24 September 2012 09:07
To: Shah Noshaba
Subject: FW: Earl Haig Memorial Hall on Elder Avenue

From: Chris Pleydell [mailto:cpleydell@hotmail.com]
Sent: 22 September 2012 18:33
To: Licensing
Subject: Earl Haig Memorial Hall on Elder Avenue

We live at 27A Fairfield Gardens with a new born baby, the junction of Elder Avenue and Topsfield Parade is already a very high noise area during the day with the cross roads, pedestrian crossing & the Queens Pub.

The idea that you could possibly give a licence allowing Earl Haig Memorial Hall to be run as a night club goes directly against the hall being used to benefit the local community.

This is a family area with young children needing sleep. We have the music venue on Topsfield Parade & the Queens which have a late licence on Friday & Saturday to Midnight. Which already creates a mess, broken glass and loud swearing during those nights, whoever it is over by midnight and for only 2 nights a week.

We totally object to the Antic Ltd late license and ask you Haringey Council to please think of the families who live in this area and the impact this will have on them as well as protecting the local community. Studies have shown peak times for violence-related call outs are between 10pm and 3.59am on Fridays/Saturdays and Saturdays/Sundays nights when a night club is open. Each call out costs on average £300 per call out to the council and call outs increase by 41% after midnight if alcohol is still being served with a steady increase of 10% for each hour thereafter.

In the 2003 Licensing Act, local authorities received a number of new responsibilities. The four main objectives of the Act are;

- prevention of crime and disorder
- public safety
- prevention of public nuisance
- protection of children from harm.

Please can you send me what consideration you have given to the above in this application.

I would also like to see Haringey's Alcohol Harm Reduction Strategy.

Regards

Mr C J Pleydell & Ms M Ashton
27A Fairfield Gardens

This email has been scanned by the Symantec Email Security.cloud service.
For more information please visit <http://www.symanteccloud.com>

17 Fairfield Road
London N8 9HG

Tel: 020 8341 0558

Fax: 020 8347 8694

23rd September 2012

Licensing Sub-Committee
Haringey Council
Civic Centre
High Road
Wood Green
London N22 8LE

Dear Sir,

Earl Haig Hall, Elder Avenue, N8 9 TH

I have noticed the application for a licence for live entertainment and recorded music made by 'Antic Ltd.' I wish to appeal on the grounds that the hours applied for are far too long and that if you were to accede to the application it would create a **public nuisance** in a densely populated residential area.

The Queens Public House adjacent to Earl Haig Hall has licensing hours that are far shorter than those applied for in your notice. I believe that the hours the Queens is open for are acceptable to the local residents and as this business has been established for years it seems that they are reasonable. My fear is that if you go beyond the licensing hours granted to the Queens, local residents will be disturbed by live and recorded music that will be broadcast unacceptably late.

The question of **public safety** is bound to come to the fore if customers of the Queens can leave after closing time and continue to drink next door, bearing in mind that all the roads in this area are busy.

The volume of the proposed entertainment will affect all the **children** in the area who will have to cope with additional noise during their sleeping hours.

Increased alcohol that would be possible if you were to grant the application must increase the possibility of more **crime and disorder** in the area.

I hope you will take my objections into account when considering this licence.

Yours faithfully,



John Eakins

17 Fairfield Road
London N8 9HG

Tel: 020 8341 0558

Fax: 020 8347 8694

23rd September 2012

Licensing Sub-Committee
Haringey Council
Civic Centre
High Road
Wood Green
London N22 8LE

Dear Sir,

Earl Haig Hall, Elder Avenue, N8 9 TH

I have noticed the application for a licence for live entertainment and recorded music made by 'Antic Ltd.' I wish to appeal on the grounds that the hours applied for are far too long and that if you were to accede to the application it would create a **public nuisance** in a densely populated residential area.

The Queens Public House adjacent to Earl Haig Hall has licensing hours that are far shorter than those applied for in your notice. I believe that the hours the Queens is open for are acceptable to the local residents and as this business has been established for years it seems that they are reasonable. My fear is that if you go beyond the licensing hours granted to the Queens, local residents will be disturbed by live and recorded music that will be broadcast unacceptably late.

The question of **public safety** is bound to come to the fore if customers of the Queens can leave after closing time and continue to drink next door, bearing in mind that all the roads in this area are busy.

The volume of the proposed entertainment will affect all the **children** in the area who will have to cope with additional noise during their sleeping hours.

Increased alcohol that would be possible if you were to grant the application must increase the possibility of more **crime and disorder** in the area.

I hope you will take my objections into account when considering this licence.

Yours faithfully,



Jill Eakins

26 FAIRFIELD ROAD
LONDON N8 9HG

23rd September 2012

Licensing Sub-Committee
Haringey Council
Civic Centre
High Road
Wood Green
London N22 8LE

Dear Sir,

Earl Haig Hall, Elder Avenue, N8 9 TH

I have noticed the application for a licence for live entertainment and recorded music made by 'Antic Ltd.' I wish to appeal on the grounds that the hours applied for are far too long and that if you were to accede to the application it would create a **public nuisance** in a densely populated residential area.

The Queens Public House adjacent to Earl Haig Hall has licensing hours that are far shorter than those applied for in your notice. I believe that the hours the Queens is open for are acceptable to the local residents and as this business has been established for years it seems that they are reasonable. My fear is that if you go beyond the licensing hours granted to the Queens, local residents will be disturbed by live and recorded music that will be broadcast unacceptably late.

The question of **public safety** is bound to come to the fore if customers of the Queens can leave after closing time and continue to drink next door, bearing in mind that all the roads in this area are busy.

The volume of the proposed entertainment will affect all the **children** in the area who will have to cope with additional noise during their sleeping hours.

Increased alcohol that would be possible if you were to grant the application must increase the possibility of more **crime and disorder** in the area.

I hope you will take my objections into account when considering this licence.

Yours faithfully,



Jack Moore

26 FAIRFIELD ROAD
LONDON N8 9HG

23rd September 2012

Licensing Sub-Committee
Haringey Council
Civic Centre
High Road
Wood Green
London N22 8LE

Dear Sir,

Earl Haig Hall, Elder Avenue, N8 9 TH

I have noticed the application for a licence for live entertainment and recorded music made by 'Antic Ltd.' I wish to appeal on the grounds that the hours applied for are far too long and that if you were to accede to the application it would create a **public nuisance** in a densely populated residential area.

The Queens Public House adjacent to Earl Haig Hall has licensing hours that are far shorter than those applied for in your notice. I believe that the hours the Queens is open for are acceptable to the local residents and as this business has been established for years it seems that they are reasonable. My fear is that if you go beyond the licensing hours granted to the Queens, local residents will be disturbed by live and recorded music that will be broadcast unacceptably late.

The question of **public safety** is bound to come to the fore if customers of the Queens can leave after closing time and continue to drink next door, bearing in mind that all the roads in this area are busy.

The volume of the proposed entertainment will affect all the **children** in the area who will have to cope with additional noise during their sleeping hours.

Increased alcohol that would be possible if you were to grant the application must increase the possibility of more **crime and disorder** in the area.

I hope you will take my objections into account when considering this licence.

Yours faithfully, *N Moore*

Nigel Moore

26 FAIRFIELD ROAD
LONDON N8 9HG

23rd September 2012

Licensing Sub-Committee
Haringey Council
Civic Centre
High Road
Wood Green
London N22 8LE

Dear Sir,

Earl Haig Hall, Elder Avenue, N8 9 TH

I have noticed the application for a licence for live entertainment and recorded music made by 'Antic Ltd.' I wish to appeal on the grounds that the hours applied for are far too long and that if you were to accede to the application it would create a **public nuisance** in a densely populated residential area.

The Queens Public House adjacent to Earl Haig Hall has licensing hours that are far shorter than those applied for in your notice. I believe that the hours the Queens is open for are acceptable to the local residents and as this business has been established for years it seems that they are reasonable. My fear is that if you go beyond the licensing hours granted to the Queens, local residents will be disturbed by live and recorded music that will be broadcast unacceptably late.

The question of **public safety** is bound to come to the fore if customers of the Queens can leave after closing time and continue to drink next door, bearing in mind that all the roads in this area are busy.

The volume of the proposed entertainment will affect all the **children** in the area who will have to cope with additional noise during their sleeping hours.

Increased alcohol that would be possible if you were to grant the application must increase the possibility of more **crime and disorder** in the area.

I hope you will take my objections into account when considering this licence.

Yours faithfully,

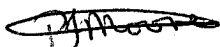

Mrs. Pamela Moore

**18 FAIRFIELD ROAD
LONDON N8**

23rd September 2012

Licensing Sub-Committee
Haringey Council
Civic Centre
High Road
Wood Green
London N22 8LE

Dear Sir,

Earl Haig Hall, Elder Avenue, N8 9 TH

I have noticed the application for a licence for live entertainment and recorded music made by 'Antic Ltd.' I wish to appeal on the grounds that the hours applied for are far too long and that if you were to accede to the application it would create a **public nuisance** in a densely populated residential area.

The Queens Public House adjacent to Earl Haig Hall has licensing hours that are far shorter than those applied for in your notice. I believe that the hours the Queens is open for are acceptable to the local residents and as this business has been established for years it seems that they are reasonable. My fear is that if you go beyond the licensing hours granted to the Queens, local residents will be disturbed by live and recorded music that will be broadcast unacceptably late.

The question of **public safety** is bound to come to the fore if customers of the Queens can leave after closing time and continue to drink next door, bearing in mind that all the roads in this area are busy.

The volume of the proposed entertainment will affect all the **children** in the area who will have to cope with additional noise during their sleeping hours.

Increased alcohol that would be possible if you were to grant the application must increase the possibility of more **crime and disorder** in the area.

I hope you will take my objections into account when considering this licence.

Yours faithfully,

Mrs. Claire Piazza

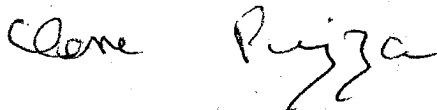

**18 FAIRFIELD ROAD
LONDON N8**

23rd September 2012

Licensing Sub-Committee
Haringey Council
Civic Centre
High Road
Wood Green
London N22 8LE

Dear Sir,

Earl Haig Hall, Elder Avenue, N8 9 TH

I have noticed the application for a licence for live entertainment and recorded music made by 'Antic Ltd.' I wish to appeal on the grounds that the hours applied for are far too long and that if you were to accede to the application it would create a **public nuisance** in a densely populated residential area.

The Queens Public House adjacent to Earl Haig Hall has licensing hours that are far shorter than those applied for in your notice. I believe that the hours the Queens is open for are acceptable to the local residents and as this business has been established for years it seems that they are reasonable. My fear is that if you go beyond the licensing hours granted to the Queens, local residents will be disturbed by live and recorded music that will be broadcast unacceptably late.

The question of **public safety** is bound to come to the fore if customers of the Queens can leave after closing time and continue to drink next door, bearing in mind that all the roads in this area are busy.

The volume of the proposed entertainment will affect all the **children** in the area who will have to cope with additional noise during their sleeping hours.

Increased alcohol that would be possible if you were to grant the application must increase the possibility of more **crime and disorder** in the area.

I hope you will take my objections into account when considering this licence.

Yours faithfully,

Peter Piazza

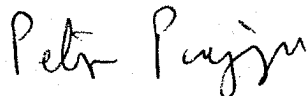

**18 FAIRFIELD ROAD
LONDON N8**

23rd September 2012

Licensing Sub-Committee
Haringey Council
Civic Centre
High Road
Wood Green
London N22 8LE

Dear Sir,

Earl Haig Hall, Elder Avenue, N8 9 TH

I have noticed the application for a licence for live entertainment and recorded music made by 'Antic Ltd.' I wish to appeal on the grounds that the hours applied for are far too long and that if you were to accede to the application it would create a **public nuisance** in a densely populated residential area.

The Queens Public House adjacent to Earl Haig Hall has licensing hours that are far shorter than those applied for in your notice. I believe that the hours the Queens is open for are acceptable to the local residents and as this business has been established for years it seems that they are reasonable. My fear is that if you go beyond the licensing hours granted to the Queens, local residents will be disturbed by live and recorded music that will be broadcast unacceptably late.

The question of **public safety** is bound to come to the fore if customers of the Queens can leave after closing time and continue to drink next door, bearing in mind that all the roads in this area are busy.

The volume of the proposed entertainment will affect all the **children** in the area who will have to cope with additional noise during their sleeping hours.

Increased alcohol that would be possible if you were to grant the application must increase the possibility of more **crime and disorder** in the area.

I hope you will take my objections into account when considering this licence.

Yours faithfully,

Melissa Piazza

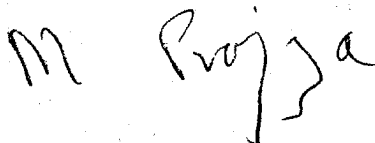
A handwritten signature in black ink, appearing to read 'M Piazza', is written over the printed name.

To: London Borough of Haringey
Licensing Team
TechnoPark
Ashley Park, Tottenham
London N17 9LN

From: SARAH HOLLAND
FLAT 2
19 FARFIELD ROAD
LONDON
N8 9HG.

25 Sept 2012.

Ref: Application for the Earl Haig Memorial Building,
Elder Avenue, London N8. to be granted a
late night licence.

I would like to strongly object to the above application on the grounds of:—

1/ The prevention of public nuisance.

As a close neighbour to the proposed building I am very concerned about the noise and general disturbance that will inevitably be made to road and surrounding residential streets.

I would also like to object on the grounds of:—

2/ The prevention of crime and disorder to the surrounding residential roads.

I hope you find the above application unacceptable for a quiet, residential, family street and area.

Yours sincerely,
Sarah Holland.

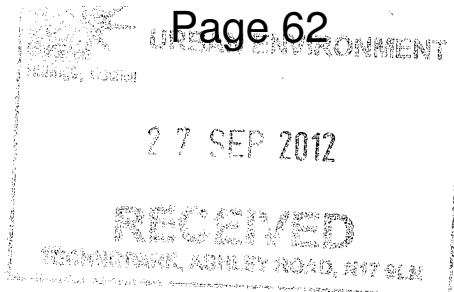

26 September 2012

OBJECTION REGARDING LICENCE APPLICATION FOR EARL HAIG SOCIAL, ELDER AVENUE, CROUCH END, LONDON N8 9TH

Name - Miki Lentin
 Address - Light House, 2A Fairfield Road, Crouch End London N8 9HG
 Email - mikilentin@fastmail.co.uk
 Mobile - 07976 793 666

Licence making representation on:

Application Number -	No application number is listed on website or notice
Name of Licensee -	Antic Ltd
Name of Premises -	Earl Haig Memorial Hall
Premises Address -	Elder Avenue, Crouch End, N8 9TH

Dear Head of Licensing at Haringey Council

I am writing to object strongly to the application for a Premises Licence by Antic Ltd for the above premises. As a local resident with a young family I would like to object to this application on the following grounds under the headings of the boroughs' four licensing objectives:

The prevention of crime and disorder

I have discussed this application with nearly 50 local residents. In fact 55 of them have signed a petition (at time of writing) that objects to this application – see appendix to this letter. Quite a few of them have signed this petition on the grounds that the addition of the Earl Haig Social as a pub to the area will have a detrimental effect on crime and disorder in the area. Please see two quotes below from the petition that reinforce that point:

"We live in a cul-de-sac at the back of the venue. We feel that turning the Earl Haig Hall into another pub will definitely cause more disturbance for us and the local area in general with the increase in people milling around, being drunk, noisy, deliveries etc in the early hours of the morning. We already have issues with people urinating / using the alleyway late at night, taxis coming down the cul-de-sac and turning, people coming down then realizing it's a dead end etc. We have a young toddler who already finds it difficult to sleep with the noise from The Queens and people returning home from the pub late at night. I very strongly object."

"As our house is right on the corner of Elder Avenue and Fairfield Gardens it would affect us in a big way. My main concerns would be more of what I have now: bottles of drink left on my drive wall, loitering, people sitting on my wall and dropping rubbish onto the drive, noise and fights. Recently I found a skirt on my drive with two piles of excrement. Although I cannot say for sure it was human excrement, along with the skirt it seems very likely. I suppose even if it is a posh Wine Bar it could still have these issues. I think it will not have a positive effect on our neighbourhood."

Further, I have spoken at length to Councillor Lyn Webber about this application. Her response by email to me included the following quotes:

"There is a past history of antisocial behaviour from the Queens Pub for example urinating in Fairfield Gardens."

"I have a concern about cumulative impact of noise, nuisance, chatting outside premises, rubbish, etc. Two groups of clientele leaving the area at closing time, whether they will clash, etc."

This outlines to me that there are significant concerns about the issue of crime and disorder that another pub on a residential street would bring. When a group of residents met recently with Antic Ltd to discuss their plans, they mentioned that a similar establishment on a residential street in Balham did not 'annoy the local neighbours too much'.

There were unable to answer specifically what that meant and further, when asked what they would do to protect clientele coming in and out of the pub late at night, they did not mention the use of a bouncer or Door Manager to help deal with dispersal of crowds etc. Finally, as the local neighbours above have mentioned, there is already a concern about crime and disorder from The Queens on Tottenham Lane, adding another pub, right next door, will only exacerbate these issues.

Public Safety

Again, I'd like to draw your attention to a couple of quotes from local residents who have supported our petition, objecting to this application.

"This application will bring disturbance and disruption into a neighbourhood already suffering degradation from hospitality-based businesses."

"I am extremely concerned at the proposal to turn Early Haig Hall into a pub, situated next door to an existing one, with licence for late night drinking both indoor and outdoor, and live music for many afternoons and nights. The negative impact on local residents will be considerable; this residential area, and the tiny cul-de-sac of Fairfield Gardens immediately opposite cannot support another drinking venue."

The key issue of public safety I believe has not been addressed by this application by Antic Ltd. Residents are very concerned that this part of Crouch End will become a destination for late night drinking. Crouch End already has a few other late night drinking establishments, such as the King's Head and Kiss the Sky amongst others. There is no need for another one, especially on a residential street.

When local residents recently met with Antic Ltd we asked specifically if they would consider not having a late night license and they said no. Having a late night license fits with their business model and they stated that they get most of their business between the hours of 10-1am Thursday to Sunday.

Further, public safety issues will arise when drinkers from the Queens move next door to the Earl Haig Social for late night drinking. This could lead to public safety issues with large amounts of people moving in and out of establishment throughout the night.

The prevention of public nuisance

Once again, please see a couple of quotes from local residents about this issue.

"Elder Avenue is a quiet residential street. A late night pub will mean loud music, late night drinkers and shouting on the street ruining the lives of the families living close by. The Queens faces the Broadway which is different to a quiet residential street and doesn't face directly on to houses. As a resident living opposite, I would rather the building was for residential use in line with all the other buildings in the street. My family would perhaps be able to sleep at night. I can't imagine this being allowed on any other residential street in Crouch End."

"In line with what we believe to be all of the other residents of Fairfield Gardens, we are extremely concerned about the prospect of a late licence being granted to the Earl Haig Memorial Hall on Elder Avenue. This is a quiet residential area which already has a pub next door to the site. This application will only add to the noise and parking problems that already affects local residents."

There is no doubt that having the Earl Haig Social next door to the Queens will create public nuisance. Many local families in the vicinity have children, myself included, and we are all concerned about the noise that will be created by having this licence agreed. Residents have complained of people throwing rubbish into front gardens, urinating and shouting whilst neighbours are trying to sleep - this will only get worse with another pub on this site.

By providing this licence, the council will be allowing Antic to play music until 01.00 from Thursday to Sunday which will have a major impact on local residents' lives. This will mean, in practice, that last orders will be at 01.00 and that drinkers will leave the pub at around 02.00. This will lead to an increase in noise from crowds leaving at the time, staff dealing with rubbish and locking the premises which could run well up to 03.00.

Further, there is the issue of parking in the area. There is already a major squeeze on parking in the area and having another pub on a residential street will exacerbate this issue further.

The protection of children from harm

Whilst there is no specific argument stating that children will be harmed by this establishment, it is however a risk that families with children will stop moving to this part of Crouch End if it becomes a haven for late night drinking.

The safety of children is important, and our family has already been subjected to vomiting on the pavement outside our house since we have lived in the neighbourhood. Children living in a residential area do not need to have another pub close by which will bring with it issues of rubbish, anti-social behaviour and noise. Providing this licence to Anti does not in my opinion protect children from harm.

Alternative solution

As you probably know there is a very viable locally-funded alternative to having a pub at the Earl Haig Hall. A local consortium tried to purchase the property for community use but got outbid at auction. While you can't influence the sale of the property, the council can do the good thing and decline this application for a licence by Antic and give the local consortium the chance to purchase the property for community use.

This would benefit all local residents not just in the immediate vicinity but also right across Crouch End. Local residents who have been interested in this campaign have all expressed that they would like the property to be used for community use. The council now has the chance to meet our needs

and requirements and not the ones of a business which will have no benefit whatsoever to the local fabric of Crouch End.

Concluding remarks

I was concerned to see that very few residents knew about this application and therefore took it upon myself to gather objections from local residents. Attached to this letter is a list of signatories from the petition that we have distributed about this issue, so you can see the strength of support for our objections.

Also, please see a quote below from Lynne Featherstone MP about this issue - *"I was very concerned to see that a pub chain intends to take over the hall without notifying local residents."*

Please also find attached a story and letter in the Hornsey Journal about this issue.

I urge you strongly to object this application on the grounds I have gone through above for the sake of the local community in this area. The whole balance of the area would change considerably if this licence application was accepted. I hope you understand the strength of feeling there is about this issue and that you will take that into consideration when assessing the application.

Please can you keep me informed of the next stage of the process as I would like to remain involved.

Yours sincerely

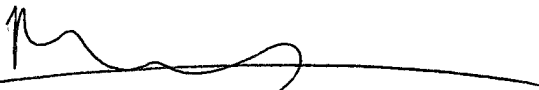
A handwritten signature in black ink, appearing to be 'Miki Lentin', with a long horizontal flourish extending to the right.

Miki Lentin

Encs.

» Contact us

EDITORIAL & PUBLISHING OFFICE
100A Avenue Road,
London NW3 3HF
Telephone 020 7433 0000
Fax 020 7433 6229

Publishing Director: John Hooker
Editor in Chief: Geoff Martin
News Editor: Stephen Moore
Sports Editor: Ben Pearce

ADVERTISING
Telephone 020 7433 0000
Fax 020 7433 6269
Display Manager: Elaine Allen

To make the news



Think it's news? Call our news desk on 020 7433 6240 and speak to the team or email journal.news@archant.co.uk

To keep up to date

On Twitter @hornseyjournal

On Facebook www.facebook.com/HornseyJournal

On our websites
www.hornseyjournal.co.uk
www.tottenhamjournal.co.uk

To place your ad

For advice on placing advertisements telephone Display Manager Elaine Allen on 020 7433 0000.

To air your views

Letters on any subject are welcomed, and must arrive by noon on Monday for consideration for that Thursday's edition. Email journal.letters@archant.co.uk or write to the address at the top of the page.

To get your paper

NEWSPAPER SUPPLY QUERIES:
020 8478 4444
distribution.queries@archant.co.uk

POSTAL SUBSCRIPTIONS:
For more details email subscription.enquiries@archant.co.uk

Free newsagent top-up line

0800 389 2682

WINDY LONDON 24
Get our FREE app for hourly weather

» Journal weather



This week's weather picture, Rainy Day, is by Aziz Cem, seven, of Harris Primary Academy Philip Lane, in South Tottenham.

The weather this weekend will be partly cloudy with a 16C high.

If your child would like to have their weather picture in the paper, send it to the address at the top of this page, marked Weather, or email stephen.moore@archant.co.uk.

Live Week

what's happening in Haringey compiled by Tim Lamden

» Events

THURSDAY 20

Mark the end of London Fashion Week with an evening of retro-style celebration, beginning with a catwalk show from a range of vintage boutiques, followed by an outdoor market packed full of fashion gems, and then the chance to dance the night away with live music from special guests, all part of Vintage Rocks! at The Boogaloo, Archway Road, N6, from 7pm. Entrance £3.

Catch the start of a new film season with a showing of 1958 classic *Touch of Evil* directed by Orson Welles, who stars alongside Charlton Heston and Janet Leigh, by the Highgate Film Society, at Highgate Literary & Scientific Institution, South Grove, N6, at 7.30pm

FRIDAY 21

Watch a Pakistani box-office smash which brings the question of women's rights to the forefront, exploring the story of a Pakistani woman on death row, with a showing of 2011 film *Bol* at the Asian Centre, Caxton Road, N22, from 6.30pm.

Kick the weekend off with a bang and laugh your socks off at a comedy night boasting a wealth of high-profile talent, with the Working Title Comedy Night, at Big Green Bookshop, Brompton Park Road, N22, from 8pm. Entrance £5.

Enjoy an evening of performances from acoustic musicians and singers performing three songs each in aid of a homeless charity, with the Three Songs charity night, at Moors Bar, Park Road, N8, from 8pm. Entrance £3.

SATURDAY 22

Celebrate the regeneration of a much-loved open space now boasting a state-of-the-art bike track and innovative eco-building housing a cafe, toilets and community room, with the Lordship Rec Community Festival 2012, offering a range of free sports and games to get involved with. Lordship Recreation Ground, Lordship Lane, N17, from 1pm.

Take a look at history as the doors swing open to the world's oldest surviving television studio, as well as a Victorian theatre, with a free Open House day, at Alexandra Palace, Alexandra Palace Way, N22, from 10am.

Spoil yourself or a loved one with a treat from a selection of vintage-inspired clothes, collectables, furniture, jewellery and accessories, with Step Inside Love: Vintage Fair at the Castle, at Bruce Castle Museum, Lordship Lane, N17, from 11am. Entrance £1.50, accompanied children free.

Reflect on the development and architecture of a London



■ Alexandra Palace (see Saturday)

suburb with the Muswell Hill Walk organised by Hornsey Historical Society, meeting at Muswell Hill Library, Queens Avenue, N10, from 2pm.

SUNDAY 23

Check out a host of historical buildings, including Georgian and Edwardian structures as well as modern developments such as Bernie Grant Arts Centre, and even a mural from contemporary artist Banksy, with an architectural walk around Tottenham Green conservation area led by Tottenham Civic Centre, meeting at Old Tottenham Town Hall, Town Hall Approach Road, N15, at 11am.

Get along to an afternoon of unforgettable live music as accomplished artists Frank

Moon and Bev Lee Harling get together to perform as part of the Live Vintage Jazz Afternoon at The Step, Myddleton Road, N22, from 3pm.

Brush up on your cycling skills with a low-cost cycle training class and free bike maintenance session, next to the cafe in Finsbury Park, N4, from 2pm. Cost £10.

MONDAY 24

Find out about Tottenham's natural elements with a showing of *Tottenham - The Wild Side*, a film by Tottenham and Wood Green Friends of the Earth, at Bruce Castle Museum, Lordship Lane, N17, from 12.15pm.

TUESDAY 25

Improve a small green space to entice visitors, cut back overgrown vegetation along a footpath and restore a boggy area to its former wetland glory with some much-needed conservation work alongside The Conservation Volunteers, meeting at The Spinney, Granville Road, N4, from 10am.

WEDNESDAY 26

Add a dash of Latino spice to your week during an intense hour of Colombian dance fitness routine Zumba, with JCW Fitness, at Coldfall School, Coldfall Avenue, N10, from 7.15pm. To book, call 07961 801914.

» Meetings

■ Council meetings, Haringey Civic Centre, N22. For updates and agendas, visit www.haringey.gov.uk

Monday, September 24:

Environment and Housing Scrutiny Panel, 6.30pm.

Other meetings

Thursday, September 20: St Ann's and Haringay Area Forum and Committee meeting, at Cyprus Kitchen, Green Lanes, N8, from 6.30pm.

Monday, September 24: Northumberland Park & White Hart Lane Area Forum and Committee meeting, at Northumberland Park Neighbourhood Resource Centre, Park Lane, N17, from 6.30pm.

Wednesday, September 26: Islington, Muswell Hill and Highgate Rotary Club meeting, at Highgate Golf Club, Denewood Road, N6, from 6.30pm.

» The top five...

...Cupcake flavours as part of National Cupcake Week 2012, according to Absolutely Cupcakes, of Gloucester Road, Broadwater Farm Estate, N17:

1. Vanilla with vanilla buttercream frosting.
2. Red velvet with cream cheese frosting.
3. Caramel with buttercream frosting.
4. Cookies and cream with buttercream frosting.
5. Carrot with cream cheese frosting.

Battle over community hall pub plan

by Tim Lamden
tim.lamden@archant.co.uk

» A Crouch End resident is hoping for support from the community after starting a petition to oppose plans to turn a much-loved community hall into a pub.

Miki Lentini, 37, of Fairfield Road, set up the online petition following a licensing application to Haringey Council from Antic Ltd to use Earl Haig Memorial Hall

as a pub. The Elder Avenue venue was sold at auction for more than £1million earlier this year to property developer City & Westminster Developments Ltd, in spite of residents' best efforts to purchase it for community use.

Families

Last week, Crouch End councillor David Winskill told the Journal there was "a feeling" residents would prefer to see the hall turned into

a pub rather than housing.

But Mr Lentini has hit back in opposition to the plans for a pub, arguing that it will cause problems with noise, rubbish and parking for nearby residents.

He said: "We would not want a pub on that site, we have families of young children very close to that site. It's a residential street at the end of the day."

Max Alderman, of Antic Ltd, said the company, which

runs a number of pubs across London, were "hopeful" of buying the hall "subject to getting the [pub] license".

Cllr Winskill is holding an informal meeting between the company and local residents to discuss the plans tomorrow (Friday).

■ If you wish to find out more about Mr Lentini's petition, visit www.ipetitions.com/petition/no-pub-at-earl-haig-hall.

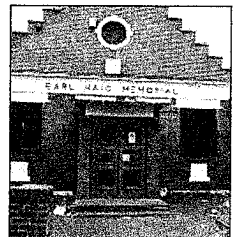

■ Earl Haig Memorial Hall

Send us your news in four simple steps with iwitness24

Become part of our reporting team with our simple-to-use website and mobile app. Send us your news, photos and videos for publication in your local newspaper and online.

IT'S EASY!

iwitness24.co.uk
Your news is our news



1 TAKE
Capture your photo/video on your camera or smartphone

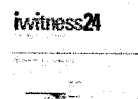

2 SEND
Register quickly and easily on the iwitness24 website or app (or just use your Facebook app!)



3 PUBLISH
See your content published on iwitness24



4 SHARE
You could see your work published in our newspapers and on websites

Find out more by going to the iwitness24.co.uk website and click Tell Me More, or search Twitter using #iwitness24 or visit our Facebook page iwitness24tendon



Download our FREE smartphone app

» Letters Send your letters to journal.letters@archant.co.uk by 12noon on Monday for inclusion in that week's paper

» Farmers market Somewhere else can be invaded

My initial reaction to your article about the proposed Farmers Market for Coleridge School in Crouch End ("Farmers' market plan could 'ruin Sundays'", Journal, September 13) was - good idea. It will mean Nightingale Lane and the Campsbourne Estate won't have to suffer an invasion every fourth Sunday when the so-called Ally Pally market sets up in Campsbourne School.

I recall no consultation before this market, which might be "far more appropriate" in Ally Pally because of the parking facilities.

But that is certainly not true when it comes to the mass of delivery trucks that drive along Nightingale Lane to service the market, which some time ago started to appear in the midst of an overcrowded, narrow area one Sunday in four.

Along with that we get those who visit - mainly Crouch Enders in large 4x4s who park inconsiderately along Nightingale Lane, Newland Road, Boyton Road, etc, unloading children and dogs roadside, ambling in the road like the locals don't need to drive!

It would appear the perfect

solution for those in Crouch End who like to use these overpriced farmer markets (unlikely to be the residents of the large Campsbourne council estate) for it to be located within walking distance in the heart of Crouch End.

Or are they, as I have long suspected, all NIMBYs in Crouch End?

Lesley Ramm
Newland Road, N8

» Wards Corner Why are other traders ignored?

I am a resident and shopkeeper in West Green Road. My home and shop would both be demolished if the Grainger plan for Wards Corner goes ahead. I have been here for 28 years.

I always read in the papers that Grainger, Haringey Council and now the Mayor of London are contributing money to help Seven Sisters Indoor Market. What about the rest of the traders on Wards Corner? We are here as well.

Why do Grainger and Haringey Council continue to ignore us? Since Grainger was granted planning permission not one senior councillor has been in contact, yet they continue to write in the papers how they are supporting us.

It is because of the council

» Letter of the week

Think carefully about impact of a pub

We are writing in response to your article "Neighbours may prefer pub plan to new housing" (Journal, September 13).

As local residents on Elder Avenue and Fairfield Road, we object strongly to the application by Antic Ltd for a late-night and alcohol licence for the Earl Haig Memorial Hall in Elder Avenue, Crouch End.

There has been no local community consultation on this application and local residents we have spoken to would not favour the opening of a pub on a residential road.

The council has confirmed that the building must be used for "community and leisure" use and not residential, but surely this does not mean yet another late-night drinking establishment in the area.

As local residents with young families, we urge the council to think carefully about the environmental, parking and social issues a pub would create and take the time to consult properly with local residents to understand what their aspirations are for the property.

We have started an online petition to object to this license application that can be found here: www.ipetitions.com/petition/no-pub-at-earl-haig-hall/

Miki Lentin and James Key
Elder Avenue and
Fairfield Road, N8



■ Earl Haig Memorial Hall

for the Stansted Express, therefore the improvements seem more to be a case of impressing foreign visitors arriving on the train from Stansted Airport.

I hope Mr Neville will now delight the users of some of the really grotty stations on this line which the tourists never notice as they speed through them - Northumberland Park, Ponders End, Brimsdown and Enfield Lock - and smarten these up too.

David Boshier
Dickenson Road, N8

» Benefits Decision must be challenged

Cllr Joe Goldberg is right to point out that the forthcoming changes to council tax benefit which will mean some of the poorest people in the borough having to pay more tax are a direct result of government policy.

However it is a result of a political decision and such things can be challenged. I hope that all the Labour Councillors in Haringey will find their way to the TUC's March for a Future That Works in central London on October 20 to underline that point.

Keith Flett
Secretary, Haringey TUC

» Toilets Don't forget the other stations

I read your report about the improvements to the toilets and other facilities at Tottenham Hale station

("Top marks for toilets", Journal, September 13) and that Alan Neville, Greater Anglia's area customer services manager, is "delighted" they scored 98 per cent in a recent survey.

But let's not forget that this is a major transport interchange with the Victoria Line and also a stop

that I will lose everything I have worked to build up, but they want nothing to do with us traders. We are all ready and willing to invest in improving our businesses and the area.

N Patel
Cosmos News,
West Green Road, N15

cashconverters
www.cashconverters.co.uk

WE BUY
INSTANT CASH FOR YOUR
UNWANTED ITEMS

WE SELL
HUGE RANGE OF QUALITY
NEW AND USED GOODS

BUY BACKS
CASH NOW... BUY BACK LATER*
*Option fee applies

PAWNBROKING
SHORT TERM LOANS AGAINST
ITEMS OF VALUE

GOLD BUYING
ALL GOOD JEWELLERY ACCEPTED
Proof of ID required. Minimum age 18.
Subject to status and affordability. Ask in-store for details.

10% OFF with this advert

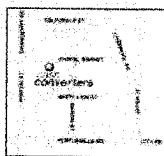

cashconverters
www.cashconverters.co.uk

86-87 Chapel Market
Islington, London, N1 9EX
Tel: 0207 837 4040

www.cashconverters.co.uk

Z E N S A I

**AUTHENTIC MALAYSIAN AND
INDONESIAN CUISINE SERVED IN
OUR MEZZANINE RESTAURANT**

Winner of 'Best themed restaurant'
at last years London food and drink awards

GROUP BOOKINGS AND PARTY
PLANNING ARE OUR SPECIALITY

Bar snacks and vegetarian options available
Specially selected wines, champagnes and
premium spirits

HAPPY HOUR AT ZENSAI

Tuesday to Thursday 5-10pm • Friday 5-10pm
Saturday 12-6pm • Sunday 12-10pm
2 for 1 on cocktails, beer & wine

As featured on worldsbestbars.com top 100 bars
world's best bars

10 Inverness St London NW1 7HL

Tel: +44 20742 19927

Email:steve@zensai.com • www.zensai.com

**We sell
bathrooms and kitchens**

**BATHROOM
CASH & CARRY**

10 Osram Road,
North Wembley,
HA9 7NG

174 Kenton Road,
Kenton,
HA3 8BL

**HIGH STOCKS AND
BIG DISCOUNTS**

0208 385 2444

www.bathroomcash.co.uk



ipetitions
YOUR VOICE COUNTS

This petition has collected
55 signatures
using the online tools at iPetitions.com

Printed on 09-26-2012

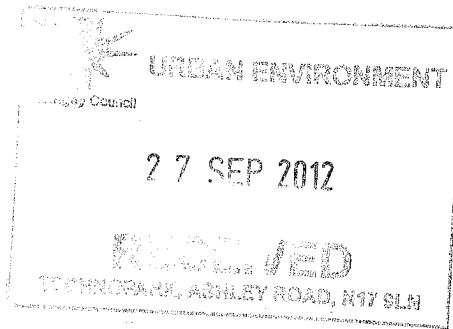

No pub at Earl Haig Hall

About the petition

Dear Local Resident

Thank you for looking at this petition regarding the Earl Haig Memorial Hall on Elder Avenue, Crouch End, N8.

You may not be aware, but Antic Ltd, an owner of pubs across London is currently applying for a late-night and alcohol license for the Earl Haig Memorial Hall, Elder Avenue, Crouch End. If successful, the pub would be able to stay open until 01.30 on weekend evenings and play live music until 11.00 and recorded music until 01.00.

Many local residents are very fond of the Earl Haig Hall and a local consortium tried to purchase the property from the British Legion so that it could be used by the local community. Unfortunately, they were vastly out-bid at auction earlier this year by City and Westminster Developments (CAWD) – a property developer.

Haringey Council has maintained throughout that the property must be kept for community use and not as a residential property. Because of Haringey's planning restrictions CAWD are now trying to cut their losses and sell it on to Antic.

Should Antic buy the property, they will re-develop the site as a pub, next door to the Queens on Elder Avenue, a residential street. There will be an increase in noise and rubbish, especially for residents next door and across the road, and no doubt another pub will have an impact on local parking. Many local residents have young children and feel strongly that the last thing a residential street needs is a pub.

The council must find a solution that benefits the local community and the hall, but another late-night drinking venue is not the answer. The council must also spend time consulting with local residents to hear what they would like to happen to the Hall.

If you wish, please sign this petition and send it on to anyone you know who lives locally who might also object to the license application. Alternatively, please write to your local councillor, in this case, Lyn Weber, Lyn.Weber@haringey.gov.uk or David Winskill, winskill@blueyonder.co.uk to express your concern.

You may also wish to write to Haringey's Licensing Team with your objection at: Enforcement Service, Technopark, Ashley Road, Tottenham, N17 9LN or email licensing@haringey.gov.uk. Deadlines for receipt of letters is **Friday 28 September**.

Many thanks for your help and I'd be happy to discuss further with you. I will aim to keep all signatories informed of developments.

Miki Lentin – mikilentin@fastmail.co.uk / 07976 793 666

Update 22 September

Dear Signatories

Many thanks for taking the time to sign the petition regarding the application by Antic Ltd for a license at the Earl Haig Hall.

Last night, myself, a few other local residents and Councillor David Winskill met with Max Alderman who is one of the partners at Antic, to give him the chance to express his case for the development of a pub in the Earl Haig Hall.

Whilst he did a good job at answering our numerous questions, I left feeling even more concerned than I did when I went into the meeting. The key point for me is that Antic is requesting a late-night license until 01.00 am from Thursday to Saturday. In practical terms, this means that they will stop serving at 01.00, which means that people will leave between 01.30 and 02.00. The doors will eventually be locked after staff have cashed and cleaned up which could be anything up to 02.30-03.00!

The noise from people milling outside the venue, shouting, calling taxis and staff getting rid of bottles and rubbish at the time of the morning, will cause a massive disturbance to the street. Further, Max did not seem to appreciate my concern that punters leaving the Queens at 11.30 will then all pile into the Earl Haig and that we could also have a situation whereby two pubs are closing at the same time, adding to disturbance that already exists in the area!

Antic seem to have good intentions – they want to ensure that they build a strong relationship with the local community and many of their pubs have won awards for being 'good pubs'. However, they seem to have a bizarre assumption that the Earl Haig will attract an older crowd and not a younger 'Kiss the Sky' or 'Kings Head' crowd. I frankly think that is nonsense as anywhere with a late license will attract a younger and therefore noisier crowd. Also, when asked if they would consider opening during normal pub hours, Max said that a great deal of their business is done between 10.00pm and 01.00am, which means a very busy pub during that time.

They believe that their application to run a pub will not need a change of use from the planning committee, so it is crucial that as many people as possible object to this. This is essentially about the fabric of this road and the surrounding roads. It will have a major impact on all of us and I would request that you send this petition to your friends and colleagues in the area asking them to sign it. The more objectors, the better chance we have of stating our case for our community. Please send your objection to the licensing team at Haringey Council – licensing@haringey.gov.uk or fill in the details on the form which can be found here - http://www.haringey.gov.uk/licensing_representation_form.pdf

Deadline is next Friday 28 September.

Thanks for your support

Miki Lentin

Fairfield Road

mikilentin@fastmail.co.uk

07976793666

Signatures

1. Name: Miki Lentin on Sep 16, 2012
Comments:

2. Name: Peta Isaac on Sep 16, 2012
Comments: we really don't need another pub (or coffee shop for that matter)

3. Name: Steve Gregson on Sep 16, 2012
Comments:

4. Name: Jay Harradine on Sep 17, 2012
Comments:

5. Name: Martin McKee on Sep 17, 2012
Comments:

6. Name: Ian Bailey on Sep 17, 2012
Comments: I strongly oppose the proposal that the Earl Haig Memorial Hall be granted a late license. This is totally out of keeping with the history of the building and is not in the interests of the local community.

7. Name: Terry Jones on Sep 17, 2012
Comments:

8. Name: Anonymous on Sep 17, 2012
Comments:

9. Name: Alan Bentley on Sep 18, 2012
Comments:

10. Name: Andrew Goldstone on Sep 18, 2012
Comments: The Earl Haig Hall should continue to be used as a community hall for which there is huge demand in Crouch End. A fully viable business plan prepared by local people willing to invest a significant sum proves this. This opportunity will be lost if the council grants planning permission and a licence for change of use of the building to a pub.

11. Name: Justin Baron on Sep 18, 2012
Comments: We do not need another pub so close to the Queens !

12. Name: Clive Levontine on Sep 18, 2012
Comments: I am a local Crouch End resident. I was part of the consortium that attempted to buy this property for community use. All our research indicated that there was a substantial demand for community space in Crouch End, both from groups which had historically used this building and other groups and other organisations who desire space in Crouch End.

In my view, a pub use is entirely inappropriate for a residential street. In any event, there are already a number of pubs on the nearby "High Streets".

13. Name: Elizabeth Elford on Sep 18, 2012
Comments: A pub would be a detriment to that area.

14. Name: Miriam Levin on Sep 18, 2012
Comments:

15. Name: Megan Royle-Jacob on Sep 19, 2012

Comments: This is a quiet residential area which already has a pub a few feet away from the site. This does not benefit anyone who lives in the local area.

-
16. Name: Saba Choudhury on Sep 19, 2012
Comments: I hope the local authority will respect the needs of the community
-
17. Name: Jazz on Sep 19, 2012
Comments: After pubs, whats next? More betting shops and fast food joints? We don't want Crouch End moving in that direction.
-
18. Name: Valerie Eaton on Sep 19, 2012
Comments: I strongly believe that the Earl Haig hall should be used for the community and not turned into another late night pub/bar which is totally inappropriate for where it is situated in a residential street.
-
19. Name: Anonymous on Sep 19, 2012
Comments: I do not even know how I ended up here, but I thought this post was great. I don't know who you are but definitely you are going to a famous blogger if you aren't already ;) Cheers!
<http://www.pandorajewelrysonline.org/>
-
20. Name: Lana Welch on Sep 19, 2012
Comments: I'm more than happy to be on this petition. There is no need for anymore pubs, wine bars in this area, we have enough. They need to use this building wisely to benefit the community.
-
21. Name: Anonymous on Sep 19, 2012
Comments:
-
22. Name: Philip Hatfield on Sep 19, 2012
Comments:
-
23. Name: Marina Jenkyns on Sep 20, 2012
Comments: I am extremely concerned at the proposal to turn Early haig Hall into a pub, situated next door to an existing one, with licence for late night drinking both indoor and outdoor, and live music for many afternoons and nights. The negative impact on local residents will be considerable; this residential area, and the tiny cul-de-sac of Fairfield Gardens immediately opposite cannot support another drinking venue.
-
24. Name: Theodora Nathanael on Sep 20, 2012
Comments: As our house is right on the corner of Elder Avenue and Fairfield Gardens it would affect us in a big way. My main concerns would be more of what I have now: bottles of drink left on my drive wall, loitering, people sitting on my wall and dropping rubbish onto the drive, noise and fights. Recently I found a skirt on my drive with two piles of excrement. Although I cannot say for sure it was human excrement, along with the skirt it seems very likely. I suppose even if it is a posh Wine Bar it could still have these issues. I think it will not have a positive effect on our neighbourhood.
-
25. Name: Raymond Ramsden on Sep 20, 2012
Comments: The occasional functions held at the Hall were a nuisance to local residents - how much worse would be a full-time pub/night club? This is just not a suitable location.
-
26. Name: Kirsty Hanly on Sep 20, 2012
Comments: I support this building's use as a community venue. We have enough pubs thank you very much.

Best wishes

Kirsty
-
27. Name: Alan Crawford RIBA on Sep 20, 2012
Comments: This is not a site that suits a change of use to accommodate a public house. There are numerous public houses in the area, many of which that are already having difficulty trading in the current economic downturn. Other more appropriate uses for the building should be explored and the application for a pub licence refused
-
28. Name: James Key on Sep 20, 2012
Comments: Elder Avenue is a quiet residential street. A late night pub will mean loud music, late night drinkers and shouting on the street ruining the lives of the families living close by. The Queens faces the Broadway which is different to a quiet residential street

and doesn't face directly on to houses. As a resident living opposite, I would rather the building was for residential use in line with all the other buildings in the street. My family would perhaps be able to sleep at night. I can't imagine this being allowed on any other residential street in Crouch End.

29. Name: Amanda Coppard on Sep 20, 2012
Comments:

30. Name: Beverley Coffin on Sep 20, 2012
Comments:

31. Name: Zeta MacDonald on Sep 21, 2012
Comments:

32. Name: Margaid Gosschalk on Sep 21, 2012
Comments:

33. Name: Sue Irwin-Hunt on Sep 21, 2012
Comments: 'Arts Street' coming soon to a community near you! X

34. Name: Evie Jeffreys on Sep 21, 2012
Comments:

35. Name: Nicla Di Palma on Sep 21, 2012
Comments: What is with late night bars in residential areas? Enough of that. Residents have rights too.

36. Name: Anonymous on Sep 22, 2012
Comments: I get pleasure from, lead to I discovered just what I used to be looking for. You've ended my four day long hunt! God Bless you man. Have a nice day. Bye
Home Page

37. Name: Jez & Alex Startup on Sep 22, 2012
Comments: In line with what we believe to be all of the other residents of Fairfield Gardens, we are extremely concerned about the prospect of a late licence being granted to the Earl Haig Memorial Hall on Elder Avenue. This is a quiet residential area which already has a pub next door to the site. This application will only add to the noise and parking problems that already affects local residents.

38. Name: Mr C Pleydell & Ms M Ashton on Sep 22, 2012
Comments: We live at 27A Fairfield Gardens with a new born baby, the junction of Elder Avenue and Topsfield Parade is already a very high noise area during the day with the cross roads, pedestrian crossing & the Queens Pub. The idea that you could possible give a licence allowing Earl Haig Hall to be run as a night club goes directly against the hall being used as a benefit to the local community. This is a family area with young children needing sleep, this is the reason we moved to this area. We already have the music venue on Topsfield Parade. We totally oppose the Antic Ltd late license and ask you Haringey Council to please think of the families who live in this area and the impact this will have on them.
Mr C J Pleydell & Ms M Ashton
27A Fairfield Gardens

39. Name: Chris Chown on Sep 22, 2012
Comments: The proposals for a potential new pub are not suitable for a residential road like Elder Avenue, and I strongly object to it.

40. Name: Linda Almond on Sep 22, 2012
Comments:

41. Name: Joel Levy on Sep 22, 2012
Comments:

42. Name: Duncan Stroud on Sep 23, 2012
Comments: totally inappropriate to have new pub in middle of residential road when so many other pubs less than 200m

-
43. Name: Darren Silver on Sep 23, 2012
Comments:
-
44. Name: Ronit Lentin on Sep 23, 2012
Comments: This is a lovely residential street which definitely does not need another pub
-
45. Name: Jean Tate on Sep 23, 2012
Comments: I live on Elder Avenue and would like to see the building used for a wide range of local community activities, not for private speculation.
-
46. Name: David Bellman on Sep 24, 2012
Comments:
-
47. Name: Tara Wyer on Sep 24, 2012
Comments: I would like to STRONGLY object to the Earl Craig Hall being turned into a pub by Antic Ltd. I have a young family and our property is only feet away from the back of the building. Noise levels from the Queens Pub and their beer garden are already an issue for us. Within the small radius of central Crouch End there are already numerous pubs and bars and I feel that the community does not need another pub / late night venue which will only add to the issues of noise pollution and unsociable behaviour at unsociable hours.
-
48. Name: Cliff Parisi on Sep 24, 2012
Comments: We live in a cul-de-sac at the back of the venue. We feel that turning the Earl Haig Hall into another pub will definitely cause more disturbance for us and the local area in general with the increase in people milling around, being drunk, noisy, deliveries etc in the early hours of the morning. We already have issues with people urinating / using the alleyway late at night, taxis coming down the cul-de-sac and turning, people coming down then realizing it's a dead end etc. We have a young toddler who already finds it difficult to sleep with the noise from The Queens and people returning home from the pub late at night. I very strongly object.
-
49. Name: Anonymous on Sep 24, 2012
Comments: L
-
50. Name: Anonymous on Sep 24, 2012
Comments:
-
51. Name: James Hadley on Sep 24, 2012
Comments: This application will bring disturbance and disruption into a neighbourhood already suffering degradation from hospitality-based businesses.
-
52. Name: Anonymous on Sep 25, 2012
Comments:
-
53. Name: Nancy Taylor-Jewell on Sep 25, 2012
Comments:
-
54. Name: Anonymous on Sep 26, 2012
Comments:

Enough is enough!

How many pubs do we need in Crouch End?
-
55. Name: Anonymous on Sep 26, 2012
Comments: Do not give us further headaches please - do not let the Earl Haigh Memorial Hall turn into another pub
-

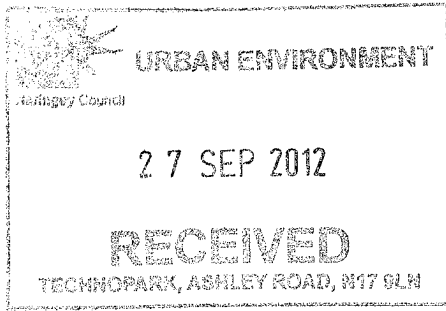

Flat 4,
13 Fairfield Rd,
N8 9HG

Wednesday, Sept 26th.

To whom it may concern

I am very concerned to hear of the potential plans for the Earl Haig Memorial building, to be turned into a nightclub venue.

I am local to this premises and enjoy the nature of the area that is quiet, peaceful and safe. I have an 11 month old baby and I am concerned that the level of public nuisance, crime & disorder will rise if such plans were to take place. Safety of my child and protection of the area's charm is fundamental to our life in Fairfield Rd.

The idea of ^{extra} noise, rubbish & disturbance to us, the local residents is

Very undesirable.

Therefore, I am writing to show
my strong objection to the scheme.
I hope you will take notice.

Carilla Overden.

Anderson Chanel

From: Nadine - Limelight Access Lifestyle [nadine@limelightaccess.com]

Sent: 27 September 2012 14:09

To: Licensing

Subject: Earl Haig Memorial

I hereby object to the Earl Haig Memorial being turned into a pub/late night venue on the grounds of it creating public nuisance and on the basis of the prevention of crime and disorder.

In addition, an event was held at the venue recently and the noise from the music made a real disturbance to us as our bedroom is literally across the road from the venue. The people spilling out from the venue at the end of the night also caused real disturbance with fighting and creating rubbish.

Nadine Brady

LIMELIGHT ACCESS LIFESTYLE[Become a fan](#)[Follow Us](#)

W: www.limelightaccess.com

E: nadine@limelightaccess.com

11-12 Great Sutton Street
Clerkenwell
London
EC1V 0BX

M: +44 (0)7779 624 139

T: +44 (0)207 017 8771

F: +44 (0)207 017 8770

This email and any files transmitted with it are confidential and intended solely for the use of the individual or entity to whom they are addressed and should not be disclosed to any other party. If you have received this email in error please notify your system manager and the sender of this message.

This email message has been swept for the presence of computer viruses but no guarantee is given that this e-mail message and any attachments are free from viruses.

This email has been scanned by the Symantec Email Security.cloud service.
For more information please visit <http://www.symanteccloud.com>

27/09/2012

Anderson Chanel

From: Amber Djemal [Amber.Djemal@candi.ac.uk]
Sent: 27 September 2012 11:24
To: Licensing
Cc: Cllr Weber Lyn; Cllr Winskill David
Subject: Development of Earl Haig Memorial - Elder Avenue N8 (HGY/2012/0624)
8A Elder Avenue, Crouch End, London N8 9TH

27.09.12

RE: Development of Earl Haig Memorial, Elder Avenue, London N8

Dear Sir/Madam,

I am writing in respect of the proposed development of the above property to express my grave concerns and state my express resistance to the proposal.

As you will be aware, Elder Avenue, where I have resided for over 20 years, is a quiet **residential street** and I strongly believe that the development of a late night venue, with a licence into the small hours, will cause considerable disorder to the neighbourhood. Both in terms of disturbing the peace and in drawing unwanted negative activity to the area, I would argue that this proposal will significantly impinge on what is currently a peaceful, ordered neighbourhood street.

The street is currently occupied by families with children - including small children - and single occupants, including women, who access their properties alone at night. The addition of a late night venue to the street, where patrons will be gathering outside the property on arrival and departure and in order to smoke cigarettes outside the venue, will cause both significant noise disruption to the street and pose an unwanted obstacle to lone residents returning to their properties at night. This represents both a disturbance and a public safety issue.

Similarly, a late night venue at which alcohol is sold will invariably lead to patrons leaving the establishment intoxicated and causing disturbance to sleeping residents in the street. This is likely to take the form of increased general noise and/or criminal damage being caused to properties and cars in the area. Intoxicated male patrons, in particular, pose a threat to lone female residents in the street, in terms of nuisance and threatening behaviour.

Late night venues attract both drug-taking and drug-dealing to them. This will raise crime in the street and surrounding area and render residents vulnerable, especially young people who may be drawn into a drug-taking scenario whilst it is present and available on their doorstep.

A late night venue will draw strangers to the street. Individuals who visit from outside the area will clearly not have the same investment in the maintenance and safety of the street/ area nor the commitment to preserving the well-being of the residents in the street. Older people, in particular, are likely to feel intimidated both by the increased numbers of young people gathering

outside the venue and by the noise and disturbance they create.

- A venue with a licence to stage live music until late in the evening and recorded music until later is inappropriate in a residential street and will cause large scale disruption / noise pollution to local residents' lives.

- An increase in rubbish in the area is probable, with patrons disposing of used bottles, glasses, cigarette butts and the packaging of snack foods in local front gardens and on garden walls. Broken glass in this respect poses a danger to both children and animals.

- Parking and access to the street will also be affected as an increased number of vehicles accessing the street will impact residents' ability to park and move freely through what is already a busy road.

It is for these reasons that I would like to register my strongest resistance to the proposed development of this historical building into a late night leisure facility.

Instead, I would propose that the residents of Elder Avenue and surrounding streets be consulted on the best use of the building and local feeling and opinion be taken into account; with a view to putting the venue to a more constructive community use that would both benefit and satisfy the needs of residents.

Yours

Ms Amber Djemal

Open Days 2012/13 Book online at <http://www.candi.ac.uk/opendays>



CITY AND ISLINGTON
COLLEGE

City and Islington College Beacon Status, rated as outstanding by Ofsted and winner of the Queen's Anniversary Prize 2007.
Disclaimer: This email, including any attachments, is intended for the recipient(s) named above. It may contain confidential or privileged information and should not be read, copied, otherwise used by any other person. The content of this email is that of the author and does not necessarily represent the views of the college. For further information visit our website <http://www.candi.ac.uk> or for general enquiries call +44 207 700 9333

This email has been scanned by the Symantec Email Security.cloud service.
For more information please visit <http://www.symanteccloud.com>

Anderson Chanel

From: Barrett Daliah
Sent: 27 September 2012 15:15
To: max@antic-ltd.com
Cc: Anderson Chanel
Subject: FW: Objection to license application for Earl Haig

Sir,
A further letter of representation for your attention.
Regards
Daliah Barrett

From: Don Shenker [mailto:donshenker@hotmail.com]
Sent: 27 September 2012 15:13
To: Barrett Daliah
Subject: Objection to license application for Earl Haig

Dear Daliah

I understand you are the licensing officer receiving any objections to the license application for the Earl Haig pub.

I would like to object to the application under the Licensing Objective for Public Nuisance. I believe a further pub on a residential street will add to the noise, disturbance and nuisance very late at night.

We already have the (excellent) Queens pub, adding another next door on a residential street will cause people to congregate outside on Elder Ave waiting for taxis etc. this will needlessly create further noise and disturbance to local residents.

On a separate note, the further density of licensed outlets will quite possibly add to alcohol related harm locally, as much international research shows. The government themselves referred to this in the latest alcohol strategy.

Crouch End needs to retain its individual and distinctive retail character – I don't believe adding another pub will help do that.

Yours,
Don Shenker
21 Birchington Rd N8 8HP

Don Shenker
donshenker@hotmail.com
Tel. 07718 316 201

Twitter [@donshenker](#)
Connect on [Linked In](#)

This email has been scanned by the Symantec Email Security.cloud service.
For more information please visit <http://www.symanteccloud.com>

Anderson Chanel

From: Barrett Daliah
Sent: 27 September 2012 15:14
To: max@antic-ltd.com
Cc: Anderson Chanel
Subject: FW: Proposed 'Earl Haigh Social' : an objection

Sir,
A further letter of representation for your attention.
Regards
Daliah Barrett

From: Sutcliffe, Adam [mailto:adam.sutcliffe@kcl.ac.uk]
Sent: 27 September 2012 15:04
To: Barrett Daliah
Subject: Proposed 'Earl Haigh Social' : an objection

Dear Ms Barrett,

I object to the plan to convert the Earl Haigh Hall on Elder Avenue , N8, into a pub, 'The Earl Haigh Social' . As a local resident, I would like this building, historically used for community activities, to find a new use that is similar, and genuinely supports our community. It is inappropriate to place a pub on a residential street – this would inevitably lead to noise and disruption to nearby residents, and could potentially lead to an increase in crime and disorder on Elder Avenue and other neighbouring streets. Such venues belong on Tottenham Lane, the main street in Crouch End, where there are vacant shopfronts available. I also do not see any sign of demand for another pub: this proposal is to place a pub right next to an existing pub, on the corner of Elder Avenue and Tottenham Lane, which is both excellent and far from overcrowded.

Yours,
Adam Sutcliffe
22 Inderwick Road
London N8 9LD

This email has been scanned by the Symantec Email Security.cloud service.
For more information please visit <http://www.symanteccloud.com>

Anderson Chanel

From: Barrett Daliah
Sent: 27 September 2012 15:13
To: max@antic-ltd.com
Cc: Anderson Chanel
Subject: FW: Earl Haig Social

Sir,
A further letter of representation for your attention.

Regards
Daliah Barrett

From: Stephen Halpern [mailto:stephenhalpern@blueyonder.co.uk]
Sent: 27 September 2012 15:02
To: Barrett Daliah
Subject: Earl Haig Social

Dear Ms Barrett

I am writing to object to the application to turn the building known as the Earl Haig Memorial Hall into a public house.

In view the granting of a licence for this building will risk creating a public nuisance and with a considerable potential for crime and disorder. It is relevant that there is already a large public house (known as 'The Queens') only a few yards from the Earl Haig Social and by allowing what will effectively be a concentration of these facilities on the corner of Elder Avenue and Tottenham Lane creates enormous potential for disorder in what is a residential area. The location of two additional venues, BG Max and the Music Palace would add to that potential creating a late licence strip that threatens to change the whole nature of what was a quiet residential area threatening increased public nuisance, crime and disorder. This application is of no real value to the community and the area which is already more than adequately served by premises with late licences.

Yours sincerely

Stephen Halpern,

10 Russell Road
London N8 8HN

: i) The prevention of crime and disorder ii) Public safety iii) The prevention of public nuisance

27/09/2012

Anderson Chanel

From: Mark Browning - BA GROUP [mbrowning@balaw.co.uk]

Sent: 26 September 2012 17:33

To: Licensing

Subject: Earl Haig Social, Elder Avenue, N8 9TH

We are instructed by Food & Fuel Limited (the owners of The Queens, 26 Broadway Parade, Crouch End) to make a representation on their behalf as an interested party with respect to the Premises Licence application by Antic Limited for Earl Haig Social, Elder Avenue, N8 9TH.

Please confirm receipt of this email and that it has been lodged as a representation by Food & Fuel Limited.

Food & Fuel objects to the application on the basis of an increase in crime and disorder, increased public nuisance and exposing children to unwelcome late night activity.

The Queens is situated adjacent to the Earl Haig Social. Food & Fuel has been operating The Queens for over six years, during which they have worked closely with the community and statutory authorities to ensure that the pub is well received. Any new Premises Licence in the immediate vicinity, let alone one trading as late as the proposed premises, is likely to lead to an increase in crime and disorder and/or public nuisance which will impact upon the good name of The Queens and inevitably damage their reputation.

The Queens has historically had to deal with noise issues in a densely residential neighbourhood, and having overcome those problems, there is a realistic fear of being held responsible for increased noise nuisance resulting from a large new premises.

The Queens is a magnificent listed building which is a prominent part of the Crouch End community. Food & Fuel are proud to operate it and to serve the community. The majority of Queens customers are local residents and regulars who walk to the pub. There are already a good choice of licensed premises serving the demand in Crouch End and in order for a new business to survive, it would have to draw customers from further afield, meaning an increase in traffic and nuisance for the local community. Food & Fuel work hard to ensure the Queens is kept to the highest possible standards and this takes a considerable investment in the building every year. The granting of a new licence would threaten the livelihood of all who work there, and indeed threaten the survival of the business. Given its historical significance to the area and its listed status, it is important it remains a vibrant pub and a less responsible owner may choose to heavily discount the alcohol offer in order to compete, which could of course lead to an increase in crime and disorder.

Further, the area is predominantly family-occupied, and a late licence will mean substantially increased late night activity such as coming and goings, taxis waiting with engines running, car doors slamming, talking in nearby roads, all of which will have an effect on those children needing to attend school early in the morning.

Mark Browning
BA LAW Limited
59 Pelham Street
London SW7 2NJ
T: 0870 458 4600
F: 0870 458 4800
M: 07956 415441

27/09/2012

E: mbrowning@balaw.co.uk
www.bagrouppltd.com

This message is confidential. It may also be privileged or otherwise protected by work product immunity or other rules. If you have received this message by mistake please let us know by reply and then delete it from your system; you should not copy the message or disclose the contents to anyone. We have taken precautions to minimise the risk of transmitting software viruses, but we advise that you carry out your own virus checks on any attachments to this message. We cannot accept liability for any loss or damage caused by software viruses.

B-A GROUP



This email has been scanned by the Symantec Email Security.cloud service.
For more information please visit <http://www.symanteccloud.com>

Shah Noshaba

From: Barrett Daliah
Sent: 27 September 2012 17:50
To: max@antic-ltd.com
Cc: Shah Noshaba
Subject: FW: Earl Haig Social

Dear Sir,
A further letter of representation for your attention.
Regards
Daliah Barrett

From: Camilla Newman [mailto:Camilla.Newman@condenast.co.uk]
Sent: 27 September 2012 17:37
To: Barrett Daliah
Subject: Earl Haig Social

Dear Daliah
We were astonished to hear that Haringey council are considering yet another pub for Crouch End, and one to be opened directly by an existing one The Queens Head. Elder Avenue is a quiet residential road and a pub on the corner will increase noise pollution and disturb the local residents. We are in the process of considering purchasing a flat on Elder Avenue and really feel that a pub on the road will devalue it enormously. Please do your best to keep the building as a public community building and not another drinking establishment which is not needed nor wanted.

Many Thanks
Camilla Newman
Coleridge School Governor
9 Bryanstone Road
London
N8 8TN

Camilla Newman
PUBLISHER, Condé Nast Brides

☎ 020 7152 3666
📠 Vogue House, Hanover Square, London W1S 1JU

The UK's No1 biggest selling bridal title
www.bridesmagazine.co.uk

The information contained in this e-mail is of a confidential nature and is intended only for the addressee. If you are not the intended addressee, any disclosure, copying or distribution by you is prohibited and may be unlawful. Disclosure to any party other than the addressee, whether inadvertent or otherwise, is not intended to waive privilege or confidentiality. Internet communications are not secure and therefore Conde Nast does not accept legal responsibility for the contents of this message. Any views or opinions expressed are those of the author.

The Conde Nast Publications Ltd (No. 226900), Vogue House, Hanover Square, London W1S 1JU

This email has been scanned by the Symantec Email Security.cloud service.
For more information please visit <http://www.symanteccloud.com>

27/09/2012

Anderson Chanel

From: Barrett Daliah
Sent: 27 September 2012 16:16
To: max@antic-ltd.com
Cc: Anderson Chanel
Subject: FW: Earl Haig Social

Sir,
A further representation for your attention.
Regards
Daliah Barrett

From: Graeme Trayner [mailto:gtrayner@brunswickgroup.com]
Sent: 27 September 2012 16:10
To: Barrett Daliah
Subject: RE: Earl Haig Social

Of course –due to the additional noise in Elder Avenue, and potential for antisocial behaviour

From: Barrett Daliah [mailto:Daliah.Barrett@haringey.gov.uk]
Sent: 27 September 2012 16:07
To: Graeme Trayner
Subject: RE: Earl Haig Social

Hello Mr Trayner

You will need to say how the application will contribute to this in order for this to be considered a valid representation.

Regards
Daliah Barrett

From: Graeme Trayner [mailto:gtrayner@brunswickgroup.com]
Sent: 27 September 2012 16:01
To: Barrett Daliah
Subject: Earl Haig Social

Dear Daliah,

I would like to object to the potential approval on this, as I think it will cause public harm.

Best,
Graeme

Graeme Trayner
Partner

Brunswick Group LLP, 16 Lincoln's Inn Fields, London, WC2A 3ED, United Kingdom
Tel +44 (0) 20 7404 5959 Direct +44 (0) 20 7396 5344 Mobile +44 7834 502344 www.brunswickgroup.com

Read *The Brunswick Review*, a journal devoted to communications and corporate relations, at www.brunswickgroup.com/review

- Brunswick is a leading international corporate relations and communications consultancy
- More than 90 Partners worldwide across 20 offices in 12 countries

04/10/2012

Barrett Daliah

From: Theodora Nathanael [theo3624@yahoo.com]
Sent: 01 October 2012 13:20
To: Barrett Daliah
Cc: Cllr Weber Lyn; Cllr Weber Lyn
Subject: Fw: Objection to Licensing the British Royal Legion to become a Public House..
Attachments: Elder Aveneue - Licensing.v2.doc

Dear Daliah Barrett

I would like Councillor Lyn Weber to speak on my behalf regarding our objection to the British Legion becoming a Public House. I cannot attend as I am a full time carer for my mother who is a dialysis patient and is very unwell. Attached is her submission in this regard.

Thank you for your help.

Yours sincerely
Theodora Nathanael
GF 23 Elder Avenue
N8 9TE

This email has been scanned by the Symantec Email Security.cloud service.
For more information please visit <http://www.symanteccloud.com>

The British Legion – Elder Avenue – an objection to the licensing application

I first met with a group of residents in Fairfield Gardens in 2006 when a range of antisocial issues was raised. At the time residents, the SNT, traders and Council services were working hard to improve the environment and investing a lot of time and effort.

I also met the Broadway Parade and Felix Avenue (rear of the Royal Legion) residents group in 2007/8 when again antisocial behaviour issues were the issue and residents, together with the SNT and Council services, were working hard to improve the environment.

With this background; given the application for a licence for the (ex) British Legion premises in Crouch End Elder Avenue I must ask:

- 1) What will granting a licence to Antic to turn the Royal Legion into a pub, bring to the area? What is the added value for the local community?

Some of the concerns are based upon the 'fall out' from existing pubs, which are responsible for a history of inebriated clientele urinating in Fairfield Gardens cul-de-sac, bottles smashed across the road or left on walls and steps, rubbish, noise from those leaving the pub, persistent chatter, loitering late at night, etc.

This prompts my second question:

- 2) How will the increase in drinking related activity impact local residents and the local community?

Residents are understandably alarmed that the applicant wants to license the Royal Legion, a building that is in close proximity to the Queens Public House, and change the use from a local community facility to a public house. The position of the Legion building is in a residential side street away from the main thoroughfare of Crouch End. It will mean that clientele will turn out directly onto a residential area and disperse in any of three directions - all of them between family houses left, right and centre. And of course any noise will travel straight to all the homes in the road.

I must also ask:

- 3) What about the rear of the building?

Currently both Felix Avenue and Broadway Parade Alley suffer noise nuisance from the Queens Pub whose garden is adjacent to the Legion. Because of the hardscape nature of the rear any sound bounces off the buildings and is amplified. The prospect of yet more noise from another public house (Legion building) is a great concern to all in the area.

Furthermore, there is a strong feeling that a change of use from a community centre to a pub will alter the character of the area, and it will not be an improvement. Elder Avenue and the surrounding streets are residential family roads. There is no escaping what happens around public houses especially the fall out at closing time, clientele no matter who they are will talk, start up cars, smoke outside the premises, etc. Whether

in high spirits or the seedier side - arguments, vomit, fight etc. And is this just the first step with worse to come - it is noticeable that more establishments are asking for later opening hours.

How does all this protect families from noise disturbance night after night? The licensing committee need to be absolutely sure that local children's sleep will not be affected. Remember, sleep deprivation affects a child's educational attainment and the family unit as a whole.

A further point:

- 4) More strangers will come to the area. If this is not the objective then presumably the aspiration is to take business away from the many other local high street public establishments, which leads to the viability of other public houses in the area.

Finally, music every night – who would like that next to their house? I ask because Live bands will no longer need a licence from October 1st between the hours of 8 and 11pm. Reassure as much as you like but noise will leak out, if only when the door opens to let someone in or out, and this could be seven nights a week. Clientele will chatter, cars and people will arrive and depart – all generating noise through to possibly 2 or 3am. It's a fact, the purpose of a pub is social drinking – and late night hours will attract clientele from pubs that close earlier.

A last question:

- 5) What steps have been taken to prevent this type of public nuisance?

I ask the Licensing Committee to refuse the licence. It means a change of use seven nights a week, and there are no safe guards to prevent public nuisance.

In the event the Committee choose to grant the licence it is imperative that the organisation be forced to work very closely with the local Community who will be directly affected to mitigate sound and all antisocial behaviour with the penalty of closure if they fail.

Thank you for your consideration

Cllr Lyn Weber
Independent Councillor for Crouch End Ward

Barrett Daliah

From: Barrett Daliah
Sent: 01 October 2012 09:50
To: 'max@antic-ltd.com'
Subject: FW: Licensing application for Earl Haig building

Dear Sir,

I am also required to pass this representation to you which arrived while I was away.

Please note that I have refused a number of other letters of representation that have arrived after the closing date. However, those people will be invited to the hearing as it is a public hearing although they will not be able to address the Licensing Sub Committee.

Regards
Daliah Barrett

Dear Licensing,

"While this premise has been licensed before, it has been for community use which has generally been unobtrusive and compatible with the local neighbourhood. This proposal would represent a material change in the way the premises would be used, moving to a commercial operation which would attract Crouch End's vibrant night life - and the problems that can be associated with the night economy - deep into a residential area.

Therefore, the impact on the local community could be considerable and should not be granted lightly, if indeed at all.

This licence request, and its late night impact, is more appropriate to a town centre location, not this residential one. Clearly the risk from late night revellers leaving this premise, or migrating to it after closing time elsewhere, could prove disruptive and lead to Public Nuisance, if not issues around Crime and Disorder."

Regards
Cllr Winskill and Cllr P Strang (Ward Members)
RPH. Members Services

Anderson Chanel

From: Barrett Daliah
Sent: 08 October 2012 14:25
To: Anderson Chanel
Subject: FW: Earl Haig social

From: Traci Watson [mailto:timothy1959@aol.com]
Sent: 27 September 2012 22:11
To: Barrett Daliah
Subject: Earl Haig social

Dear Ms. Barrett,
I object to the proposal for a new Crouch End pub to be called the Earl Haig social. Given the proposal to close at 1 a.m., the pub seems highly likely to bring significant levels of noise, traffic and litter to a residential street. I hope you will reconsider on the basis that the proposal will cause a public nuisance.
Sincerely,
Traci Watson
83 Hornsey Lane Gardens
London, N6 5PA

This email has been scanned by the Symantec Email Security.cloud service.
For more information please visit <http://www.symanteccloud.com>

Anderson Chanel

From: Barrett Daliah
Sent: 08 October 2012 14:27
To: Anderson Chanel
Subject: FW: Formal objection to Earl Haig Social

From: Russell Vandyk [mailto:russellvandyk@yahoo.co.uk]
Sent: 27 September 2012 22:25
To: Barrett Daliah
Subject: Formal objection to Earl Haig Social

Dear Ms Barrett

I would like to submit a formal objection to the proposed pub at the old Earl Haig Hall to be called the Earl Haig Social. Crouch End has enough pubs already and the risk of public disorder through the increase in people who have drunk too much is real. There is already the Queens Pub in front of the hall which meets the needs of local drinkers without adding yet another pub premises.

Russell Vandyk
50 Warham Road N4 1AT

This email has been scanned by the Symantec Email Security.cloud service.
For more information please visit <http://www.symanteccloud.com>

Anderson Chanel

From: Barrett Daliah
Sent: 08 October 2012 14:26
To: Anderson Chanel
Subject: FW: Earl Craig

-----Original Message-----

From: Carrie Adams [mailto:carrie.adams@newsint.co.uk]
Sent: 27 September 2012 17:13
To: Barrett Daliah
Subject: Re: Earl Craig

Thanks, full address is 34 Gladwell Road, N8 9AA.

By creating a pub that stays open til late in a residential street, I believe that this will contribute to a public nuisance, by encouraging people to drink late into the night, without adequate transport links to move them away quickly, next door to an already popular pub. The potential owners have said themselves that they serve the most drinks between 10-1 am so that people will be incredibly drunk by the time they leave, putting pressure on already tight local police resources.

Not to mention the noise and disturbance on what is a residential street. It is often the case that people leave empty bottles, cigarette ends, talk loudly, shout at each other, walk and sit on parked cars outside pubs when they have been drinking for 4 or 5 hours.

Does that suffice as a complaint or do you need more?

Carrie Adams

0207 782 6769
carrie.adams@newsint.co.uk

News International
2 Thomas More Square
London, E98 1HR

On 27 Sep 2012, at 18:05, Barrett Daliah <Daliah.Barrett@haringey.gov.uk> wrote:

> Dear Madam,

>

> Sorry, but this cannot be accepted as a valid representation as you
> have not addressed any of the four licensing objectives to show how
> this application will impact on ; The prevention of crime and disorder
> Prevention of public nuisance Protection of children from harm and
> Public safety.

>

> We will be happy to accept a revised letter showing how you feel the licensable activities being applied for and the hours purposed, or the conditions offered at Part P do not address or would undermine the four objectives.

>

> Please also include your address to make the representation valid.

>

> Regards

> Daliah Barrett

> Licensing Team Leader

>
> -----Original Message-----
> From: Carrie Adams [mailto:carrie.adams@newsint.co.uk]
> Sent: 27 September 2012 16:52
> To: Barrett Daliah
> Subject: Earl Craig
>
> Hello, I'd like to register my official complaint about the proposal to turn this building into another pub. Besides the fact that Crouch End doesn't need any more watering holes, there is a clear case put forward to the council by the community (a consortium who were willing to put their money where their mouth is) that a large number of local people would like it to be used for the good of the community.
>
> In a proactive and conscientious neighbourhood such as ours, I would have though that the council would do their best to support this 'big society' approach to enhancing neighbourhood spirit, building community understanding between differing religions, races and ages and providing a local space, at no extra cost to the council?
> Particularly at a time of austerity and cuts to local budgets.
>
> I really hope you will listen to the people that live here.
>
> Carrie Preston
> Gladwell Road
>
> --
>
> --
> "Please consider the environment before printing this e-mail"
>
> Newsworks - bringing advertisers and newsbrands together
> www.newsworks.org.uk
>
> This e-mail and any attachments are confidential, may be legally privileged and are the property of NI Group Limited on whose systems they were generated. NI Group Limited is the holding company for the News International group, is registered in England under number 81701, has its registered office at 3 Thomas More Square, London E98 1XY and VAT number GB 243 8054 69. If you have received this e-mail in error, please notify the sender immediately and do not use, distribute, store or copy it in any way. Statements or opinions in this e-mail or any attachment are those of the author and are not necessarily agreed or authorised by NI Group Limited or any member of its group. NI Group Limited may monitor outgoing or incoming emails as permitted by law.
> It accepts no liability for viruses introduced by this e-mail or attachments.
>
>
> -----
> This email has been scanned by the Symantec Email Security.cloud service.
> For more information please visit <http://www.symanteccloud.com>
> -----
>
> This email and any files transmitted with it are confidential, may be subject to legal privilege and are intended only for the person(s) or organisation(s) to whom this email is addressed. Any unauthorised use, retention, distribution, copying or disclosure is strictly prohibited. If you have received this email in error, please notify the system administrator at Haringey Council immediately and delete this e-mail from your system. Although this e-mail and any attachments are believed to be free of any virus or other defect which might affect any computer or system into which they are received and opened, it is the responsibility of the recipient to ensure they are virus free and no responsibility is accepted for any loss or damage from receipt or use thereof. All communications sent to or from external third party organisations may be subject to recording and/or monitoring in accordance with relevant legislation.
>
> -----
> This email has been scanned by the Symantec Email Security.cloud service.
> For more information please visit <http://www.symanteccloud.com>

This page is intentionally left blank

HARINGEY COUNCIL

Agenda Item
Page No. 1

Licensing Act 2003 Sub-Committee on 18th October 2012

Report title: Application for a Review of a Premises Licence at Turkish Cypriot Community Association, 628-630 Green Lanes, Hornsey, London N8 0SD

Report of: The Licensing Team Leader

Ward(s) affected Harringay

- 1. Purpose**
To consider an application by The Enforcement Response Team for a review of the premises licence at Turkish Cypriot Community Association.

Summary of application

- The applicants – Enforcement Response as a Responsible Authority are seeking a review of the Premises Licence with reference to the licensing objectives of the Prevention of Public Nuisance.

Date review application served: 12th September 2012

In accordance with regulation 38 of the Licensing Act 2003 (Premises and Club Premises Certificates) Regulations 2005, officers arranged for notices of the review to be published for 28 days on the affected premises, on the public notice board at the Civic Centre and on the Council's website.

A copy of the review application and supporting documents are at Appendix 1.

2. Officers Observations

In determining this application the Licensing Sub Committee must have regard to the:

- 2.1**
- (a) need to promote the four licensing objectives
 - (b) representations
 - (c) relevant sections of the statutory guidance to licensing authorities (appendix 2)
 - (d) relevant sections of the licensing authority's statement of licensing policy (appendix 3)

Report authorised by: Joan Hancox

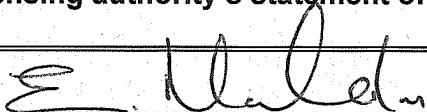

Head of Neighbourhood Services

Contact Officer: Ms Daliah Barrett -Williams

Telephone: 020 8489 8232

3. Access to information:

Local Government (Access to Information) Act 1985

Background Papers

The following Background Papers are used in the preparation of this Report:

File: TURKISH CYPRIOT COMMUNITY ASSOCIATION

The Background Papers are located at Enforcement Service, Technopark, Ashley Road, Tottenham, London N17 9LN

This page is intentionally left blank

4. REPORT

Background

Multiple breaches of conditions listed on current premises licence. Enforcement Response have not been satisfied that the required conditions have been met.

Licensable activities authorised by the Licence:

The times the Licence authorises the carrying out of licensable activities:

The Provision of Regulated Entertainment:

Plays & Films

Monday to Saturday	1900 to 2300 hours
Sunday all licensable activities will cease at	2200 hours

Live Music, Recorded Music, Performances of Dance, Provision of facilities for dancing & Provision of facilities similar to that of making music or dancing

Thursday to Saturday	1900 to 2300 hours
Sunday	1900 to 2200 hours

New Years Eve and Christmas Eve:	1900 to 0200 hours
----------------------------------	--------------------

Provision of Late Night Refreshment:

New Years Eve and Christmas Eve only:	2300 to 0200 hours
---------------------------------------	--------------------

Supply of Alcohol:

Monday to Saturday	1900 to 2230 hours
Sunday	1900 to 2130 hours

New Years Eve and Christmas Eve:	1900 to 0130 hours
----------------------------------	--------------------

The designated premises supervisor is: Mr Hasan Ozoncu

4.2.1 Details of the Application for Review and Supporting Documentation. Appendix 1

The application for the review has been made on the following grounds:

The operation of the premises has failed to uphold the Licensing Objectives of The Prevention of Public Nuisance.

The license was granted by a Licensing Sub Committee subject to certain conditions being met. The premises licence holder was unable to make use of the license until such time the conditions imposed in relation to the prevention of public nuisance were satisfactorily completed. The licensing Authority have not been advised of these measure being carried out since the grant of the license.

5.0 RELEVANT REPRESENTATIONS (CONSULTATION)

Responsible authorities:

5.1 Comments of Metropolitan Police

No representation made.

5.2 Comments of Regulatory Services:

Have made representation regarding this application. **APP1**

5.3 Comments of The London Fire and Emergency Planning Authority

No representation made

6.0 Comments of Interested Parties

Letter of representation have been received against this application **APP2**

7.0 POLICY CONSIDERATIONS

7.1 The following provisions of the Licensing Act 2003 apply to this application: Section 51-53 (review of premises licenses)

In determining the application the Licensing Sub Committee can take such steps as it considers necessary for the promotion of the licensing objectives, which are:

1. Take no further action
2. modify the conditions of the license
3. exclude a licensable activity from the scope of the license
4. remove the designated premises supervisor
5. suspend the license for a period not exceeding three months
6. revoke the license.

Where the Licensing Sub Committee takes steps mentioned in 3 or 4 it may provide that the modification or exclusion is to have effect for one such period (not exceeding three months) as it may specify. The Licensing Sub Committee is asked to give full reasons for its decision.

The Licensing Sub Committee must make its decision within 5 working days of the end of the hearing. Any decision of the Licensing Sub Committee is stayed from coming into effect for 21 days from the date of the decision, pending any appeal that might be made and the determination of that appeal. Any party to the proceedings may appeal against the decision of the Licensing Sub Committee.

8.0 The following provisions of the Secretary of State's guidance apply to this application: Paras 2.33-2.40, 8.60, 11.5. These provisions are attached at Appendix 3.

- 8.1 The following paragraphs of the licensing authority's Statement Of Licensing Policy apply to this application; page 24 'Public nuisance', these provisions are attached at **Appendix 4**.
- 8.2 The Licensing Sub Committee is reminded that the Human Rights Act 1998 guarantees the right to a fair hearing for all parties in the determination of their civil rights. The Act also provides for the protection of property which may include licences in existence, and the protection of private and family life.

APPENDIX 1 – APPLICATION BY ENFORCEMENT RESPONSE

WK/225141

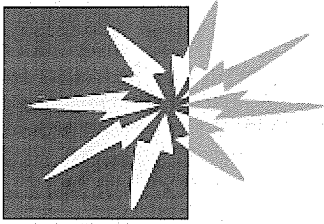

Haringey Council

Contact us | Online services

A | B | C | D | E | F | G | H | I | J | K | L
 M | N | O | P | Q | R | S | T | U | V | W
 X | Y | Z



Review of Premises Licence or Club Premises Certificate

Please confirm the details you have entered

Please check the information below. If you want to make any amendments, please use the 'Previous Page' button and make your changes. If you are happy with it, press 'Submit Request' to send this form to us.

Part 1 - Premises details

Premises address	628-630 Turkish Cypriot Community Association Green Lanes Hornsey London N8 0SD
Telephone number at premises	020 8826 1080 <i>if any</i>
Name of premises licence holder or club holding club premises certificate	<i>if known</i>
Number of premises or club premises certificate	00007857 <i>if known</i>

Part 2 - Applicant details

Please state whether you are applying for a premises licence as 2) a responsible authority

(C) Details of Responsible Authority applicant

Name	George Roberts
Address	Lee Valley Technopark Ashley Road Tottenham London N17 9LN

Contact details

Tel: 020 8489 5238

Tel:

Fax:

Email: george.roberts@haringey.gov.uk

P - Licensing Objectives

This application to review relates to the following licensing objective(s)

- 1) the prevention of crime and disorder ☐
- 2) public safety ☐
- 3) the prevention of public nuisance ☒
- 4) the protection of children from harm ☐

Please state the ground(s) for review

If there is not enough space here, you can upload an additional document on the 'supporting documents' page

Multiple breaches of conditions listed on the current premises licence. We the relevant responsible authority have not been satisfied that the required conditions have been met in the section of the licence which states "The premises licence is granted only once the Licensing Authority has provided written confirmation to the Applicant that it has been satisfied that all the required conditions have been met to the satisfaction of the Responsible Authorities". This has not been ratified by Licensing. *The ground(s) for review must be based on one of the licensing objectives*

Please provide as much information as possible to support the application

If there is not enough space here, you can upload an additional document on the 'supporting documents' page

Please list any additional information or details, for example dates of problems which are included in the grounds for review, if available.

Previous reviews

Have you made an application for review relating to these premises before?

Equal opportunities information

What is your ethnic group?
(Please select one option from the drop-down list)

If 'other', please specify

Do you consider that you have a disability?

Your gender

I understand that I must print the application form and send my signed printout to the Licensing Team, to validate this application. *



Submit Application



12/9/12

◀ Previous Page

LICENSING ACT 2003

Sec 24

Licensing Consultation

To: Licensing Officer

From: Enforcement Response Officer (Noise)

Name of Officer preparing representation: George Roberts

cc: Team Leader Enforcement Response, Derek Pearce

Our Reference: WK225141

Date: 6th October 2012

Premises: Cyprus Kitchen, 628-630 Green Lanes, London, N8 0SD

Type of application: Review

Introduction

The premises have been operating outside of their current premises licence and we have noted breaches of the licence and licence conditions. Little apparent effort has been made to address the items, especially those conditions which appear to have the most impact on local residents with regard to noise nuisance.

We have requested a review of the premises licence to address the lack of progress on these issues and disregard of licensing requirements, and conditions imposed by the licensing sub-committee when the premises licence was originally issued.

No communication has been sent from us (the responsible authority) to grant the current premises licence, and the premises have been operating as though the licence has been granted throughout the period since it was issued, even after being warned. This means that the premises has been operating under a license that has not been validated and licensable activity taking place has effectively been unlicensed/unauthorised.

In making this review we are seeking clarification on the terms of the Premises Licence to ensure that the Premises Licence holder promotes the Prevention of Public Nuisance.

We have reproduced the Premises Licence below with our comments [square brackets] below

PREMISES LICENCE

Receipt: AG946925

Premises Licence Number: LN00007857

This Premises Licence has been issued by:

***The Licensing Authority, London Borough of Haringey,
Technopark, Ashley Road, Tottenham
London N17 9LN***

LICENSING ACT 2003
Sec 24

Signature:.....

Date: 29th January 2010

Part 1 – PREMISES DETAILS

Postal Address of Premises or, if none, Ordnance Survey map reference or description:

**TURKISH CYPRIOT COMMUNITY ASSOCIATION
628-630 GREEN LANES
HARINGEY
LONDON N8 0JD**

Where the Licence is time limited, the dates:

The premises licence is granted only once the Licensing Authority has provided written confirmation to the Applicant that it has been satisfied that all the required conditions have been met to the satisfaction of the Responsible Authorities.

[No written confirmation has to date been provided and therefore the premises licence according to the wording is not granted. This apparent discrepancy needs to be clarified]

Licensable activities authorised by the Licence:

The Provision of Regulated Entertainment: Plays, Films, Live Music, Recorded Music, Performances of Dance, Provision on facilities for dancing and Provision of facilities similar to that of making music or dancing

Supply of Alcohol

Provision of Late Night Refreshment

The times the Licence authorises the carrying out of licensable activities:

The Provision of Regulated Entertainment:

Plays & Films

Monday to Saturday	1900 to 2300 hours
Sunday all licensable activities will cease at	2200 hours

Live Music, Recorded Music, Performances of Dance, Provision of facilities for dancing & Provision of facilities similar to that of making music or dancing

Thursday to Saturday	1900 to 2300 hours
Sunday	1900 to 2200 hours

New Years Eve and Christmas Eve:	1900 to 0200 hours
---	---------------------------

Provision of Late Night Refreshment:

New Years Eve and Christmas Eve only:	2300 to 0200 hours
--	---------------------------

Supply of Alcohol:

LICENSING ACT 2003

Sec 24

Monday to Saturday	1900 to 2230 hours
Sunday	1900 to 2130 hours

New Years Eve and Christmas Eve:	1900 to 0130 hours
----------------------------------	--------------------

The opening hours of the premises:

Monday to Friday	0900 to 2300 hours
Saturday	1200 to 2300 hours
Sunday	1200 to 2200 hours

New Years Eve and Christmas Eve:	0900 to 0200 hours
----------------------------------	--------------------

Where the Licence authorises supplies of alcohol whether these are on and/or off supplies:

Supply of alcohol for consumption **ON** the premises only.

Part 2

Name, (registered) address, telephone number and e-mail (where relevant) of holder of Premises Licence:

Turkish Cypriot Community Association
628-630 Green Lanes
Haringey
London N8 0JD

Telephone: 020 8826 1080

E-mail: info@tcca.org

Registered number of holder, for example company number, charity number (where applicable):

1080926

Name, address and telephone number of designated premises supervisor where the Premises Licence authorises the supply of alcohol:

Personal Licence number and issuing authority of personal licence held by designated premises supervisor where the Premises Licence authorises for the supply of alcohol:

Z01N1048FL/1

Issued by: London Borough of Waltham Forest

Expires: 09/07/2019

Annex 1 –Mandatory Conditions

(2) Supply of alcohol: No supply of alcohol may be made under the premises licence-

- (a) at a time when there is no designated premises supervisor in respect of the premises licence, or
- (b) at a time when the designated premises supervisor does not hold a personal licence or his personal licence is suspended.

(3) The second condition is that every supply of alcohol under the premises licence must be made or authorised by a person who holds a personal licence.

Exhibition of films:

(2) Where the film classification body is specified in the licence, unless subsection (3) (b) applies, admission of children must be restricted in accordance with any recommendation made by that body.

(3) Where-

- (a) the film classification body is not specified in the licence, or
 - (b) the relevant licensing authority has notified the holder of the licence that this subsection applies to the film in question,
- admission of children must be restricted in accordance with any recommendation made by that licensing authority.

(4) In this section-

“children” means persons aged under 18; and

“film classification body” means the person or persons designated as the authority under section 4 of the Video Recordings Act 1984.

Annex 2 – Conditions consistent with the Operating Schedule

THE PREVENTION OF CRIME AND DISORDER

Measurements will be taken to avoid any incidents by introducing a calming period during the last one hour of events. During the calming periods the music will be lowered and attendants to the event will be encouraged/warned to leave the premises quietly at the end of the events to avoid disturbance to the neighbours. Also during the events over consumption of alcohol will not be allowed.

PUBLIC SAFETY

Turkish Cypriot Community Centre will have an up to date risk assessment and will have achieved all the recommendations. There will also be a health and safety policy in place which will be used on a day to day basis.

THE PREVENTION OF PUBLIC NUISANCE

The building will be sound insulated and visitors will be warned to leave the building quietly to ensure that nearby residents are not disturbed.

Acoustic Sound Insulation

Acoustic Sound Insulation will be provided to all external walls of the licensable area of the property in order to eliminate the noise disturbance and acoustic sound test certificates will be provided to the relevant council departments.

[evidence of sound Insulation provided to external walls and acoustic sound test certificates have not been provided]

Operating hours

That regulated entertainment ceases no later than 23:00 on Monday through Saturday and no later than 22:00 on Sunday.

Prevention of nuisance from noise/vibration

All doors and windows will remain closed during the regulated entertainment licensed activities.

The doors leading to the rear garden will be kept shut during the regulated entertainment licensed activities and used only for emergency egress

Adequate and suitable mechanical ventilation should be provided to public areas

[evidence of suitable mechanical ventilation has not been provided]

Annex 2 – Conditions consistent with the Operating Schedule

Structure borne noise

All speakers are mounted on anti-vibration mountings to prevent vibration transmission of sound energy to adjoining properties

Sound limits

The licensee shall ensure that no music played in the licensed premises is audible at or within the site boundary of any residential property

All regulated entertainment amplified activity will utilise the in-house amplification system, the maximum output of which is controlled by the duty manager

All sound systems and equipment will be connected to this sound level checking and limiting equipment by a professional sound engineer and the report obtained from the sound engineer will be submitted to the Noise Team.

[confirmation that a limiting device has been fitted and set up is requested]

Outside Areas

No music will be played in, or for the benefit of patrons in external areas of the premises

No form of loudspeaker or sound amplification equipment is to be sited on or near the exterior premises or in or near any foyer, doorway, window or opening to the premises

Signs shall be displayed in the external areas/on the frontage requesting patrons to recognise the residential nature of the area and conduct their behaviour accordingly.

The rear garden/frontage will be out of bounds to members of the public / users of the premises whilst regulated entertainment is in progress.

Plant and machinery

All plant and machinery is correctly maintained and regularly serviced to ensure that it is operating efficiently and with minimal disturbance to neighbours arising from noise

Dealing with complaints

A complaints book will be held on the premises to record details of any complaints received from neighbours. The information is to include, where disclosed, the complainant's name, location, date time and subsequent remedial action undertaken. This record must be made available at all times for inspection by council officers

Regular quarterly liaison meetings will be held to enable neighbours to raise concerns about any aspect of the licensed activities where this is requested by any local resident.

Patrons entering/exiting premises.

Signs should be displayed requesting patrons to respect the neighbours and behave in a courteous manner

Prevention of nuisance from light

Security lights will be positioned to minimise light intrusion to nearby residential premises

The Applicant is also to supply two contact telephone numbers that local residents may use to report any complaints. Those numbers must be available during the licensable hours.

THE PROTECTION OF CHILDREN

Turkish Cypriot Community Centre will have a Child Protection Policy in place.

Annex 2 – Conditions consistent with the Operating Schedule

Alcohol may only be sold to individuals over the age of 18 with valid proof of identification with one of the following:

- A valid passport
- A photo driving license issued in a European Union Country
- A proof of age standard card system
- A citizen card, supported by the Home Office

Annex 3 – Conditions attached after a hearing by the licensing authority

RESOLVED

To grant the application by Turkish Cypriot Community Association, 628-630 Green Lanes, London N8 0JD, to allow Provision of Regulated Entertainment, Supply of Alcohol and Provision of Late Night refreshment at the premises as follows:

Provision of Regulated Entertainment:

Plays & Films

Monday to Saturday 1900 to 2300 hours
Sunday all licensable activities will cease at 2200 hours

Live Music, Recorded Music, Performances of Dance, Provision of facilities for dancing & Provision of facilities similar to that of making music or dancing

Thursday to Saturday 1900 to 2300 hours
Sunday 1900 to 2200 hours

New Years Eve and Christmas Eve: 1900 to 0200 hours

Provision of Late Night Refreshment:

New Years Eve and Christmas Eve only: 2300 to 0200 hours

Supply of Alcohol (for consumption ON the premises):

Monday to Saturday 1900 to 2230 hours
Sunday 1900 to 2130 hours

New Years Eve and Christmas Eve: 1900 to 0130 hours

Opening Hours

Monday to Friday 0900 to 2300 hours
Saturday 1200 to 2300 hours
Sunday 1200 to 2200 hours

New Years Eve and Christmas Eve: 0900 to 0200 hours

[The following sections should be clarified to ensure that there is no doubt in regard to the position of the conditions of the Licence]

The conditions outlined by the Noise Team for the prevention of public nuisance (as set out on pages 46 and 47 of the agenda pack) are to be imposed together with the conditions set out by the Applicant in the operating schedule and the Applicant's letter to the Environmental Health Officer, dated 21st January 2010, including air-conditioning.

The Applicant is also to supply two contact telephone numbers that local residents may use to report any complaints. Those numbers must be available during the licensable hours.

For the avoidance of doubt; the premises licence is to be granted only once the Licensing Authority has provided written confirmation to the Applicant that it has been satisfied that all the required conditions have been met to the satisfaction of the Responsible Authorities.

Annex 3 – Conditions attached after a hearing by the licensing authority

The licence will be subject to a review if the conditions are not met.

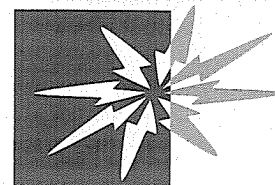

Haringey Council

Supporting InformationTable Below Shows Incidents Listed after 29th January 2010 when Licence issued

Date reported & time	Subject	Observations & time	Outcome	Our Ref
3/2/10 @2034 hrs	Car horns + Loud voices	@2041 Complainant called back	Noise had stopped	119298 (30)
19/5/10 @2116 & @2126 hrs	Loud music	@2210 Visit made by enforcement officer	Statutory nuisance not established	119298 (33 & 34)
2/6/10 @1956 & @2005 hrs	Loud music	@2022 Visit made by enforcement officer – Centre management advised that complaints received	Statutory nuisance not established	119298 (31 & 32)
13/6/10 @1705 & @1745 hrs	Loud music	@1750 Enforcement officer visited and could hear and see some people in the rear garden of the property. Some noise from children also - Enforcement officer visited other complainant at 1755 hrs and made observations from rear of the Cyprus Kitchen premises. Observed people came and went from inside the premises out to the rear garden. Kids playing running around etc. Rear doorway open. No other noise heard. After about 20 mins officer went round to the Cyprus Kitchen premises and spoke to a Mr Hassan. He explained that there had been a meal for a group of people who were going off to "Mecca" on a religious trip. There had been no entertainment, no party, just a gathering for a meal. There was no evidence of any licensable activities at all. Mr Hassan was aware of the requirements for sound insulation and air conditioning etc. No "events" were planned until such works completed and authorization given to go ahead	Statutory nuisance not established	119298 (35 & 36)
21/6/10 @2232 & @2245 hrs	Loud music	@2321 & @2325 Complainants called back	Noise had stopped	119298 (37 & 38)
10/7/10 @1207 hrs	Noise from venue	@2041 Complainant called back	Noise had stopped	119298 (39)
9/10/10 @1959 & @2022 hrs	Loud music	@2140 Enforcement officer visited and observed rear door of venue was closed, no noise heard. Officer entered the Cyprus Kitchen, tables set out for a meal for lots of people. No sign of alcohol being consumed, no sign of any licensable entertainment having taken	Statutory nuisance not established	119298 (40 & 41)

Annex 3 – Conditions attached after a hearing by the licensing authority

		place. No further action taken		
1/1/11 @0210 hrs	Loud music	@0221 Complainant called back	Noise had stopped	119298 (42)

Annex 3 – Conditions attached after a hearing by the licensing authority

8/1/11 @2242 & @2337 hrs	Loud music	@2349 Enforcement officer visited, no noise heard. Observed several tables set up in rows for a sit down meal. Nobody seated and only staff clearing up, customers had left. There were some musical instruments stacked at the side of the room. They were not set up as if ready for use. No music heard. No further action taken	Statutory nuisance not established	119298 (43 & 44)
30/1/11 @0105 hrs	Loud music	@0203 Enforcement officer visited and observed that premises was quiet, last few people just leaving	Statutory nuisance not established	119298 (45)
24/6/11 @2105 & @2115 & @2118 & @2207 hrs	Loud music	@2236 Enforcement officer visited complainant but noise witnessed was not excessive all through the visit. Officer then went to Cyprus Kitchen and got management to shut the only door that they left open at the rear	Statutory nuisance not established	119298 (46, 47, 48 & 49)
8/1/12 @2008 & @2040 hrs	Loud music	@2100 Enforcement officer visited and music from Cyprus Kitchen could be heard clearly in Harringay Gardens. However in complainant's premises the music was not loud enough in the officer's opinion to be considered a statutory nuisance. Officer then spoke to manager of premises Mr Ali Osman and cautioned him (See pages 81 to 83 from Caution Notebook of George Roberts) in relation to unlicensed regulated entertainment. Loud music was stopped by manager and he was informed by the officer that a report would be made which would likely result in further action regarding the incident	Statutory nuisance not established + Licensing warning letter dated 30/1/12	119298 (50 & 51)
19/2/12 @1819 & @1843 & @2029 & @2245 hrs	Loud music	@2010 Enforcement officer visited and observed some low level music, not a nuisance. Enforcement officer revisited at 2100 hrs could hear a low level bass noise, but it wasn't a nuisance. However the officer went to the Cyprus Kitchen and spoke to a Mr Osman, licence holder. There was a wedding going on in the rear room with live music and a live singer using a microphone. Mr Osman said he regretted allowing the booking and said he had made it clear to the people renting the hall that the music finish at 10 pm. He was having problems controlling the event. He also said there was very	Letter sent regarding proposal to review premises licence in relation to the licensing objective of public nuisance - letter dated 21/2/12.	119298 (52, 53, 54 & 55)

		<p>little English spoken by the people at the party. He did say that he would make sure it stopped at 10 pm. he would control the music level as best he could, but whenever he turned down the sound level on the mixer, they turned it up again. There didn't seem to be a limiter in use. Enforcement officer revisited at 2335 hrs and some music heard, which was not loud enough in his opinion to be a nuisance, however, event seemed to be continuing after licensed hours. Officer went round to the premises and spoke again to Mr Osman, who said he had been trying to get the people to stop and leave but without success. He had not called police. Officer removed the power cables to the amp and keyboard and explained to the party goers that the event should have finished at 10 pm. They were fairly argumentative and things got a little heated, but people did begin to leave. Although Mr Osman had tried to stop the event at the time the licence required, he had failed to do so and had taken no further action, i.e. calling police. He said to officer that he fully regrets having had the event and said he wouldn't have any more. He did seem remorseful but officer did point out to him that it is his responsibility to end such events and as such it is he that could be in trouble in such circumstances</p>		
24/6/12 @1928 & @2139 & @2152 hrs	Loud music + Loud voices	@1938 & @2202 & @2208 & @2329 Complainants called back	Noise had stopped	119298 (56, 57 & 58)
7/7/12 @1934 & @1943 hrs	Loud music	@2034 Enforcement officer visited complainant but music coming from the Cyprus Kitchen was not loud enough to be a statutory nuisance although it was noted that window open at rear. At 2047 hrs officer then spoke to Mr Ali Osman (manager) and discussed problem. Officer also examined the premises licence and after noting section headed "Where the Licence is time limited, the dates", requested to see	Multiple breaches of premises licence leading to current premises licence review	119298 (59 & 60)

		<p>letter from licensing confirming that all conditions had been met to their satisfaction. Mr Osman could not show me any such letter and the officer confirmed that the premises did not have a TEN authorising licensed activity for the night. Mr Osman was either carrying out unlicensed activity if licence not granted (even though issued) or there were multiple breaches of the premises licence which had been issued which are as follows:</p> <ul style="list-style-type: none"> • No acoustic sound test certificates available to prove any sound insulation had been installed – Breach in section “Acoustic Sound Insulation” • Rear window open during regulated entertainment – Breach in section “Prevention of nuisance from noise/vibration” • No mechanical ventilation in premises – Breach in section “Prevention of nuisance from noise/vibration” • No anti-vibration mountings on speakers being used for regulated entertainment in venue – Breach in section “Structure borne noise” • Music although not a statutory nuisance could be heard and was “audible” in complainants property – Breach in section “Sound limits” • Musicians were plugged directly into 		
--	--	---	--	--

		<p>their own amplifiers and speakers not using in house amplification system – Breach in section “Sound limits”</p> <ul style="list-style-type: none"> • No report received from a professional sound engineer regarding the connection of “sound level checking and limiting equipment” - Breach in section “Sound limits” • No visible signs on frontage exterior or in interior of premises requesting patrons “respect neighbours and behave in a courteous manner” – Breach in 2 sections titled “Outside areas” and “Patrons entering/exiting premises” • No complaints book available – Breach in section “Dealing with complaints” • Complainant said that contact telephone numbers had not been provided by venue for use during licensable events – Breach in section “Prevention of nuisance from light” <p>Officer advised Mr Osman that report to be made, but that as event taking place was a wedding he was required to reduce music volume and keep windows shut. Complainant said windows were still open when updated of visit and officer re-entered Cyprus Kitchen to confirm windows were shut</p>		
--	--	---	--	--

Annex 3 – Conditions attached after a hearing by the licensing authority

Table Below Shows Incidents Listed Before 29th January 2010 When Licence Issued

Date reported & time	Subject	Observations & time	Outcome	Our Ref
15/12/06	Loud music	N/A	Warning letter issued regarding loud music.	Predates changeover to M3 but noted on officers observation reports
24/2/07 @2114 hrs	Loud music + Voices	@2135 Offer of visit declined	Noise had stopped	21426
9/6/07 @2117 & @2140 hrs	Loud music	@2259 Officer visited complainant's premises and noise was not a problem – Officer then went to source of noise and discussed problem with party host	Statutory nuisance not established	36259 + 34568
26/10/07 @2218 hrs	Loud music + Voices	Officer visited (time not confirmed but somewhere between 2218 hrs & 2300 hrs) some music and voices heard when in complainant's rear bedroom. not a nuisance, but we visited the Cyprus kitchen and spoke to a Mr Hassan, organiser. Over 100 people in rear room having meal with music. music will be going off at 2300hrs music will be turned down until then	Statutory nuisance not established	52104
21/12/07	Loud music + Voices	@2213 Complainant called back	Noise had stopped	58847
30/3/08 @1633 & @1706 & @1719 hrs	Loud music + Voices	@1720 Officer visited complainant, music level had gone down, Officer visited Cyprus Kitchen and gave advise re keeping both rear porch door open, advised to ensure one is always closed to prevent noise escaping.	Statutory nuisance not established	69908 + 69906 + 69909
12/4/08 @2107 & @2208 hrs	Loud music	@2223 Officer visited complainant and heard loud intrusive music in their bedroom – Officer then visited Cyprus Kitchen and spoke to the man in charge who had music turned off – Officer advised on levels of music – Officer enquired if the premises had a licence for entertainment and was told that the owner was looking into it – Officer then served noise abatement notice on man in charge.	EPA Section 80 Noise abatement notice served + Licensing warning letter re unauthorised regulated entertainment dated 14/4/08	71480 + 71486

10/5/08 @2100 & @2139 hrs	Loud music	@2226 Officer visited area – Music could be heard from outside front of premises – Officer then entered Cyprus Kitchen and went to the rear of the premises and noticed that both porchway doors to garden/yard were wide open – Officer then spoke to manager and reminded him that one or both porch doors should be shut when playing music – Officer was informed that because premises had no air conditioning the doors were open to let air in – Officer told them to shut doors and keep music volume down and that report would be made	Nuisance confirmed - Reported	75714 + 75718
11/5/08 @1800 & @1800 &	Loud music	@1915 & @1920 Complainants called back	Noise had stopped	77606 + 77611
11/5/08 @1957 & @1959 & @2049 hrs	Loud music	@2125 Officer visited complainant's property and loud intrusive music witnessed coming from Cyprus Kitchen – Officer then visited Cyprus Kitchen and spoke to Mrs Turkey Hadji-Filippou a committee member and served a noise abatement notice – Music volume was reduced and rear porch door closed.	EPA Section 80 Noise abatement notice served	77921 + 77930 + 77616
20/6/08 @2311 & @2313 hrs	Loud music + Car horns + Loud voices	@0059 Officer visited	Statutory nuisance not established	79906 + 79907
23/6/08 @2154	Loud music + Loud voices	@2210 Complainant called back	Noise had stopped	80224
29/6/08 @1505 hrs	Loud music	@1640 Officer visited and observed BBQ going on at the Cyprus Kitchen. Tables and chairs set out in rear garden. Heard some loud music for about 7 minutes. Not long enough to take action on. Officer went to the Cyprus Kitchen and spoke to a lady who said she was in charge. Officer then tried to explain to her about the loud music, which had been played on a small stereo near the open rear doors, and was still switched on. A group of people then surrounded officer and began arguing about whether the noise was too loud etc. Officer decided to leave as the situation was getting out of hand, and he was working alone	Statutory nuisance not established	80957
5/10/08 @2302 hrs	Loud music	@2335 Officer visited location and observed there was a function on at the Cyprus Kitchen with a DJ playing, upon arrival music level was not loud and people were leaving. Spoke to DPS who stated they had just finished	Statutory nuisance not established	93655

Annex 3 – Conditions attached after a hearing by the licensing authority

26/4/09 @2126 & @2245 hrs	Loud music	@2211 & @2336 & @2338 Complainants called back	Noise had stopped	117778 + 117777
27/4/09 @2141 & @2219 hrs	Loud voices	@2147 & @2243 Complainants called back	Noise had stopped	117994 + 117996
10/5/09 @1634 & @1646 hrs	Loud music	@1815 Officer visited but no music heard but lots of people seen inside premises and in the rear garden – Officer entered Cyprus Kitchen and could see party balloons in the rear hall and a music system – Officer then spoke to Mr Hassan who said he worked there who said it was a private party and that they had applied for a licence	Statutory nuisance not established + Licensing warning letter dated 20/5/09	119298 (1 & 2)
29/5/09	N/A	N/A	Letter from licensing to Cyprus Kitchen management	119298
6/6/09 @2310 & @2329 hrs	Loud music	@2327 & @2346 Complainants called back	Noise had stopped	119298 (7 & 8)
13/6/09 @1539 & @1658 hrs	Loud voices	@1555 No response at complainant's address – Officer then visited Cyprus Kitchens and noted that there appeared to be a celebration function, approx 70 people seen inside	Statutory nuisance not established	119298 (9 & 10)
23/5/09 @1922 hrs	Loud voices	@2030 kids now gone inside by the time officer visited	Statutory nuisance not established	119298 (11)
22/6/09 @2253 hrs	Loud music	@2308 Complainant called back	Noise had stopped	119298 (12)
26/6/09 @2324 hrs	Loud music	@2333 Complainant called back	Noise had stopped	119298 (13)
26/9/09 @2013 hrs	Loud music	@2040 Officer observed some people seen inside the centre dancing the waltz or similar sort of dance, not really an event	Statutory nuisance not established	119298 (14)
26/9/09 @2148 & @2149 hrs	Loud music	@2359 Officer visited area - all quiet with 3 persons on premises - No noise or other activity evident	Statutory nuisance not established	119298 (15 & 16)
11/11/09 @2016 & @2050 hrs	Noise from venue	@2115 Officer visited area but no noise witnessed	Statutory nuisance not established	119298 (17 & 18)
28/11/09 @1749 & @1756	Loud music + Windows open	@1836 Heavy rain meant that rear door now shut and music turned down	Noise had stopped	119298 (19 & 20)

Annex 3 – Conditions attached after a hearing by the licensing authority

28/11/09 @2018 & @2052 hrs	Loud music	<p>@2210 Officer visited Complainants premises and faint music heard, but not loud enough to be formally actionable. Officer advised complainant they would speak to venue management</p> <p>@2225 Officer spoke to Mr Hassan Ali (manager) And advised him to make sure windows at rear remained shut + rear doors kept closed + to finish music at 2300 hrs sharp + to consider reducing volume of music</p>	Statutory nuisance not established	119298 (21 & 22)
19/12/09 @2247 & @2313 hrs	Loud music	@2330 Visit made (Premises had temporary event notice until 11 pm) and loud music audible. Spoke to premises management and told to turn off music	Licensing warning letter dated 20/12/09	119298 (23 & 24)
31/12/09 @2139 & @2200 hrs	Loud music	@2240 music barely audible from complainant's location. Licensing offence, regulated entertainment without license	Licensing warning letter dated 1/1/10	119298 (26 & 27)
1/1/10	Pro-Active visit	@0200 Very faint music heard outside - Not a problem in officer's opinion during visit	Statutory nuisance not established	119298 (29)

APPENDIX 2 – LETTER OF REPRESENTATION FROM ‘OTHER PARTIES’

Anderson Chanel

From: harringaygardens [harringaygardens@blueyonder.co.uk]
Sent: 30 September 2012 16:20
To: Licensing
Cc: Barrett Daliah
Subject: Re: Licensing review: Cyprus Kitchen, 638-640 Green Lanes, N8 0SD
To: Haringey Council Licensing Team - licensing@haringey.gov.uk
From: Residents of 2, 4, & 6 Harringay Gardens - harringaygardens@blueyonder.co.uk

30th September 2012

Re: Licensing review: Cyprus Kitchen, 638-640 Green Lanes, N8 0SD

The number of late night events that have taken place at the Cyprus Kitchen since the licensing hearing in January 2010 have been few and far between, and in recent times we have not had a problem with noise at the rear of the building.

The residents of Harringay Gardens whose houses back on to the Cyprus Kitchen's rear garden have no objection to them holding a license for the Sale of Alcohol, Regulated Entertainment and Provision of Late Night Refreshment providing the conditions of the license, agreed and documented at the licensing hearing in January 2010, are adhered to.

These conditions included:

1. Residents must not be able to hear any noise emitting from the Cyprus Kitchen in any part of their property.
2. The doors and windows at the rear of the Cyprus Kitchen are to remain closed at all times, and patrons are not allowed to smoke or cause any noise in the garden at any time.
3. Air conditioning to be fitted to the Cyprus Kitchen to allow ventilation due to the stipulation that windows and doors are to be kept closed.
4. Sound proofing to be fitted through out the building.
5. Residents to be given 3 phone numbers to contact the Cyprus Kitchen owner/manager in the event of a problem out of hours.

All parties at the licensing hearing in 2010 were told that points 3 – 5 as shown above had to be completed and an inspection carried out by the council before the license came into effect; however none of three conditions have ever been implemented, and therefore we believed a license was not currently held by the Cyprus Kitchen, until we were made aware of this review.

Yours faithfully
Jean (2), Ken (4) and Pauline (6)

This email has been scanned by the Symantec Email Security.cloud service.
For more information please visit <http://www.symanteccloud.com>

APPENDIX 3 – EXTRACT FROM SECTION 182 GUIDANCE

PUBLIC NUISANCE

- 2.33 The 2003 Act enables licensing authorities and responsible authorities, through representations, to consider what constitutes public nuisance and what is appropriate to prevent it in terms of conditions attached to specific premises licences and club premises certificates. It is therefore important that in considering the promotion of this licensing objective, licensing authorities and responsible authorities focus on the effect of the licensable activities at the specific premises on persons living and working (including those carrying on business) in the area around the premises which may be disproportionate and unreasonable. The issues will mainly concern noise nuisance, light pollution, noxious smells and litter.
- 2.34 Public nuisance is given a statutory meaning in many pieces of legislation. It is however not narrowly defined in the 2003 Act and retains its broad common law meaning. It is important to remember that the prevention of public nuisance could therefore include low-level nuisance, perhaps affecting a few people living locally, as well as major disturbance affecting the whole community. It may also include in appropriate circumstances the reduction of the living and working amenity and environment of other persons living and working in the area of the licensed premises.
- 2.35 Conditions relating to noise nuisance will normally concern steps appropriate to control the levels of noise emanating from premises. This might be achieved by a simple measure such as ensuring that doors and windows are kept closed after a particular time, or more sophisticated measures like the installation of acoustic curtains or rubber speaker mounts. Any conditions appropriate to promote the prevention of public nuisance should be tailored to the type, nature and characteristics of the specific premises. Licensing authorities should be aware of the need to avoid inappropriate or disproportionate measures that could deter events that are valuable to the community, such as live music. Noise limiters, for example, are very expensive to purchase and install and are likely to be a considerable burden for smaller venues.
- 2.36 As with all conditions, those relating to noise nuisance may not be appropriate in certain circumstances where the provisions of the Environmental Protection Act 1990, the Noise Act 1996, or the Clean Neighbourhoods and Environment Act 2005 adequately protect those living in the area of the premises. But as stated earlier in this Guidance, the approach of licensing authorities and responsible authorities should be one of prevention and when their powers are engaged, licensing authorities should be aware of the fact that other legislation may not adequately cover concerns raised in relevant representations and additional conditions may be appropriate.
- 2.37 Where applications have given rise to representations, any appropriate conditions should normally focus on the most sensitive periods. For example, music noise from premises usually occurs from mid-evening until either late-evening or early-morning when residents in adjacent properties may be attempting to go to sleep or are sleeping. In certain circumstances, conditions relating to noise immediately surrounding the premises may also prove appropriate to address any disturbance anticipated as customers enter and leave.

- 2.38 Measures to control light pollution will also require careful thought. Bright lighting outside premises considered appropriate to prevent crime and disorder may itself give rise to light pollution for some neighbours. Applicants, licensing authorities and responsible authorities will need to balance these issues.
- 2.39 In the context of preventing public nuisance, it is again essential that conditions are focused on measures within the direct control of the licence holder or club. Conditions relating to public nuisance caused by the anti-social behaviour of customers once they are beyond the control of the licence holder, club or premises management cannot be justified and will not serve to promote the licensing objectives. However, premises should have adequate dispersal policies (where appropriate) in place to ensure that customers leave the premises promptly and with minimal disruption to those in the surrounding area.
- 2.40 Beyond the immediate area surrounding the premises, these are matters for personal responsibility of individuals under the law. An individual who engages in anti-social behaviour is accountable in their own right. However, it would be perfectly reasonable for a licensing authority to impose a condition, following relevant representations, that requires the licence holder or club to place signs at the exits from the building encouraging patrons to be quiet until they leave the area and to respect the rights of people living nearby to a peaceful night.

PROTECTION OF CHILDREN FROM HARM

- 2.41 The protection of children from harm includes the protection of children from moral, psychological and physical harm. This includes not only protecting children from the harms associated with alcohol but also wider harms such as exposure to strong language and sexual expletives (for example, in the context of exposure to certain films or adult entertainment).
- 2.42 The Government believes that it is completely unacceptable to sell alcohol to children. Conditions relating to the access of children where alcohol is sold and which are appropriate to protect them from harm should be carefully considered. Moreover, conditions restricting the access of children to premises should be strongly considered in circumstances where:
- adult entertainment is provided;
 - a member or members of the current management have been convicted for serving alcohol to minors or with a reputation for allowing underage drinking (other than in the context of the exemption in the 2003 Act relating to 16 and 17 year olds consuming beer, wine and cider when accompanied by an adult during a table meal);
 - it is known that unaccompanied children have been allowed access;
 - there is a known association with drug taking or dealing; or

refurbishment of premises) which in themselves may not be significant, but which cumulatively may impact adversely on the licensing objectives. This emphasises the importance of having an up-to-date copy of the premises plan available.

- 8.59 An application to remove a licensable activity should normally be approved as a minor variation. Variations to add the sale by retail or supply of alcohol to a licence are excluded from the minor variations process and must be treated as full variations in all cases.
- 8.60 For other licensable activities, licensing authorities will need to consider each application on a case by case basis and in light of any licence conditions put forward by the applicant. For example, the addition of live or recorded music to a licence may impact on the public nuisance objective, but this will depend on many factors. Licensing authorities will need to consider factors such as proximity to residential areas and any noise reduction conditions volunteered by the applicant. It is expected that in general applications to vary a licence for live music should benefit from the minor variations process unless there is likely to be an adverse impact on the licensing objectives. Similarly, in some circumstances, the addition of other types of regulated entertainment, such as the performance of plays or exhibition of films, to a licence may have no adverse impact on the licensing objectives.
- 8.61 In considering applications to add licensable activities, licensing authorities and officers may find it helpful to consider the following factors:
- the nature of the licensable activity;
 - proximity of the premises to residential areas;
 - any licence conditions volunteered by the applicant to mitigate the impact of the activity;
 - whether alcohol is sold at the premises when the licensable activity is taking place;
 - whether alcohol will continue to be sold during the extended period (for example, a pub that applies to stay open an extra hour after the sale of alcohol has ended to sell hot drink and food could be considered to benefit the promotion of the licensing objectives);
 - the track record of the premises – whether positive or negative (for example, any complaints or enforcement action related to the licensing objectives, or conversely any evidence of good practice in carrying on the licensable activity, such as under TENs); and
 - proximity to, and density of, public houses, nightclubs, etc. if customers from these other premises are likely to be attracted to the proposed licensable activity in large numbers (for example, people visiting a takeaway after leaving a public house).

This is not an exhaustive list and licensing officers should bring their own experience and knowledge of licensing to bear when considering applications.

APPENDIX 4 – STATEMENT OF LICENSING POLICY

premises and customers are only protected by door supervisors with an SIA licence.

14.0 The prevention of public nuisance

- 14.1 Licensed premises, especially those operating late at night and in the early hours of the morning can cause a wide range of nuisances that can impact on the people living, working or sleeping in the vicinity of the licensed premises. The Council is committed to protecting the residents and businesses in the vicinity of these licensed premises.
- 14.2 In particular, late night activities cause much of this nuisance. Late night cafés, clubs, pubs and restaurants can have a number of adverse effects on the residents in the vicinity of these premises. Nuisance such as noise, litter, anti-social behaviour, lights and odour all contribute to the loss of amenity to the general public.
- 14.3 Noise nuisance is of particular concern; music, people talking, ventilation equipment and traffic can all be disturbing especially at night when ambient noise is low.
- 14.4 The conduct of customers leaving premises or spilling out into public and open spaces is often a source of disturbance and anti-social behaviour. Problems can include littering, the breaking of glasses and bottles, vomiting and urination.
- 14.5 Fly posting or any other illegal methods of displaying advertisements relating to a licensed premises or events is considered to be a public nuisance and will not be tolerated by the Council. The Council will take action (including prosecuting) those that fly post and will support action by other Councils against those that fly post.
- 14.6 The Council is aware of the importance of the licensing trade to the local economy and its culture and leisure aspirations. Accordingly, it will try and work together with individuals and bodies who are able to make objection to licence applications, the statutory agencies and licensed businesses to ensure that licensed premises can provide a service in a responsible way and co-exist with the wider community.
- 14.7 In considering all licensed applications, the Licensing Authority will consider the adequacy of measures proposed to deal with the potential for nuisance and/or anti-social behaviour having regard to all the circumstances of the application. The Licensing Authority will expect applicants to address these issues under prevention of public nuisance when preparing the Operating Schedule:
 - Amplified music – noise from music played on the premises